

POWER DRILL

2022





FORNITURA
SUPPLY



ASSISTENZA
ASSISTANCE



CONSULENZA
ADVICE



PROGETTAZIONE
PLANNING

MISSION & VALUE

Azienda italiana composta da persone giovani e responsabili che si adoperano in ogni momento per offrire ai propri clienti soluzioni concrete e facilmente fruibili attraverso un servizio accurato e accogliente.

Operando in mercati sempre più esigenti, la POWER DRILL ritiene necessaria una continua ed accurata considerazione del fattore qualità.

Dietro ogni problema c'è un'opportunità.

Power drill ha una gamma completa di utensili di ricambio in costante evoluzione.

utensili in carburo di tungsteno cementato per scavi di fondazione, estrazione mineraria, sistemi di scavo a disco o catena, fresatura stradale, stabilizzazione delle terre e perforazioni orizzontali, inoltre aste da perforazione, alesatori, bit di perforazione, grasso ramato e filtri di tutti i tipi.

Siamo orgogliosi di potervi offrire produttività ed efficienza.

Noi di Power drill abbiamo una filosofia molto semplice: offrire il miglior prodotto possibile al miglior prezzo possibile. Grazie ad un controllo rigoroso dei processi produttivi e all'utilizzo dei materiali più performanti, produciamo solo prodotti di alta qualità.

Possiamo garantire un servizio completo a tutti gli utilizzatori di attrezzature per macchine da scavo o perforazione, dall'assistenza tecnica alla fornitura del ricambio professionale.

Professionalità, cortesia ed elevata competenza tecnica sono le caratteristiche principali che ci contraddistinguono.

Un ampio magazzino logistico situato in Italia e distribuito su una superficie molto vasta è in grado di supportare in ogni momento qualsiasi richiesta, effettuando spedizioni rapide su tutto il territorio nazionale ed internazionale.

MISSION & VALUE

We are an italian company with a young and responsible staff who always work to offer to their costumers concrete and easy-to-use solutions through an accurate and friendly service.

Operating in an increasingly demanding market, POWER Drill believes it is necessary to maintain an high level of quality.

Behind any problem there is an opportunity!

Power Drill has a complete range of interchangeable tools in constant evolution, tungsten carbide tools for excavation, mining, trenching, excavation chain and wheel system, road milling, soil stabilization and horizontal directional drilling, furthermore HDD drill rods, reamers, perforation bits, copper grease and any kind of filters.

We are proud to offer you productivity and efficiency.

Power Drill has a simple philosophy: we offer you the best possible product at the best possible price.

Thanks to a strict production processes control and the use of the most powerful materials, we only produce high quality products.

We guarantee a complete service to all users of excavators or drilling equipment, from technical assistance to professional spare parts.

Being professional and having an high technical skills are the hallmarks of our service.

A large warehouse located in Italy is able to support any requests at any time, making fast shipments throughout national and international territory.

POLICY

Power drill e' prodotto da Giori Ricambi S.r.l.

le Informazioni contenute in questo catalogo costituiscono una guida di riferimento alla gamma prodotti POWER DRILL; questi sono soggetti a modifiche e migliorie da parte di POWER DRILL la quale si riserva il diritto di apportare modifiche ai dati tecnici in ogni momento e senza alcun tipo di preavviso. Questo catalogo NON puo' essere riprodotto interamente o parzialmente senza il consenso scritto di POWER DRILL. Alcune informazioni usate per redigere il presente catalogo provengono da esistenti documenti tecnici dei quali la POWER DRILL non puo' essere tenuta responsabile per possibili errori.

per sapere di piu' sulla gamma completa dei prodotti POWER DRILL contatti il numero +039 0365823280 o scriva una mail a info@powerdrill.info

Il marchio Power drill e' proprieta' di GIORI RICAMBI SRL

POLICY

Power Drill is produced by Giori Ricambi Srl.

The informations contained in this catalogue represent a reference guide to the range of products POWER DRILL; those are subjects to modifications and improvements by POWER DRILL which reserves the right to modify the technical informations in very moment and without notice. This catalogue can't be reproduced, entirely or partially, without express written consent by POWER DRILL.

Some of the informations used to edit this catalogue come from existing documents, in case of error POWER DRILL can't be consider in charge.

To know more on the range of products and services by POWER DRILL, please contact +39 (0) 0365 823280, or write an email to info@powerdrill.info

The Power Drill brand is owned by Giori Ricambi Srl

L'utensile giusto al momento giusto
the right tool for your application

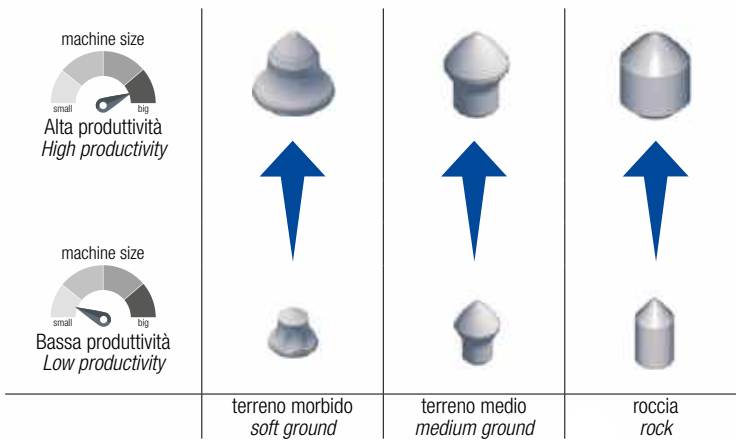

Diametro del gambo in mm
Shank diameter mm

Classificazione di durezza della roccia
Rock hardness classification

condizioni di taglio <i>Cutting conditions</i>	descrizione <i>description</i>	caratteristiche <i>features</i>	esempi di rocce <i>Rocks examples</i>
 leggere / <i>light</i>	roccia molto tenera e non compatta, non stratificata. Compressione della roccia da 0 a 35 Mpa. <i>very soft and not solid rock, not stratified. Rock compression from 0 to 35 Mpa.</i>		Steatite/ <i>Steatite</i> Argillite/ <i>Argillite</i> Lignite/ <i>Lignite</i>
 medie / <i>medium</i>	roccia tenera o medio dura, a stratificazione media. Compressione della roccia da 20-60 Mpa. <i>soft or medium / hard rock, medium. Stratification rock compression from 20-60 Mpa.</i>		Calcare/ <i>Limestone</i> Caliche/ <i>Caliche</i> Bauxite/ <i>Bauxite</i> Antracite/ <i>Anthracite</i> Marna/ <i>Marl</i>
 pesanti / <i>heavy</i>	roccia da medio dura a dura, compatta. Compressione delle roccia tra 50-100 Mpa. <i>from medium / hard rock to hard rock solid. Rock compression between 50-100 Mpa.</i>		Dolomite/ <i>Dolomite</i> Calcare/ <i>Limestone</i>
 complesse / <i>complicated</i>	roccia dura e compatta a spessa stratificazione. Compressione della roccia > 80 Mpa. <i>hard and solid rock with thick stratification. Rock compression > 80 Mpa.</i>		Granito/ <i>Granite</i> Basalto/ <i>Basalt</i> Minerale di ferro/ <i>Iron minerals</i> (ematite, magnetite/ <i>hematite, magnetite</i>)

Selezione della punta giusta per la macchina e l'applicazione
Select the right tip for the machine and the application

**A SPINA CILINDRICA
 STRAIGHT PIN**

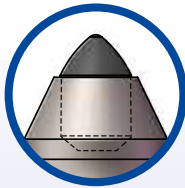

- Tenacità massima.
- Condizioni: roccia dura, roccia frantumata, roccia di cava, roccia mista e terra.
- Ideale per condizioni ad altissimo impatto.
- *Max toughness.*
- *Conditions: hard rock, crushed rock, cave rock, mixed soil rock.*
- *Ideal for very high risk conditions.*

**A CAPSULA
 CAPSULE**

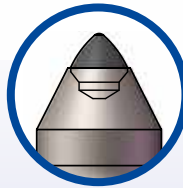

- Massima resistenza all'abrasione.
- Condizioni: materiale morbido o abrasivo.
- Ideale per condizioni ad impatti NON elevati.
- *Maximum abrasive resistance.*
- *Condition: soft or abrasive material.*
- *Ideal for not high impact conditions.*

**A FUNGO
 TIGHT PIN**

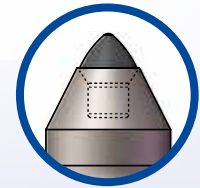

- Combinazione tra una punta a capsula e una punta a spina cilindrica.
- Condizioni: condizioni: eccellente con materiale duro e abrasivo.
- *Combination between a capsule pin and a straight pin.*
- *Conditions: excelent with hard and abrasive material.*

**A FONDO PIATTO
 FLAT PIN**

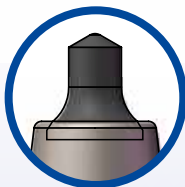

- Massima resistenza all'abrasione.
- Condizioni: Materiale più morbido e abrasivo.
- Aiuta a deviare il materiale dal corpo in acciaio riducendone l'usura derivata dal materiale abrasivo
- Consigliato su aree che non richiedono una penetrazione elevata.

Non resisterà ad alto impatto.

- Maximum resistance to abrasion
- Conditions: Softer and more abrasive material
- Helps deflect material from the steel body reducing the wear caused by the abrasive material
- Recommended on areas that do not require high penetration.

It will not withstand high impact



immagine ingrandita del carburo di tungsteno di inserti per condizioni di scavo **dure e complesse**

Enlarged image of tungsten carbide insert for **tough** and **complex excavation** conditiond



immagine ingrandita del carburo di tungsteno di inserti per condizioni di scavo **morbide e abrasive**

Enlarged image of tungsten carbide insert for **soft** and **abrasive excavation** conditiond







FRESATURA STRADALE
road milling

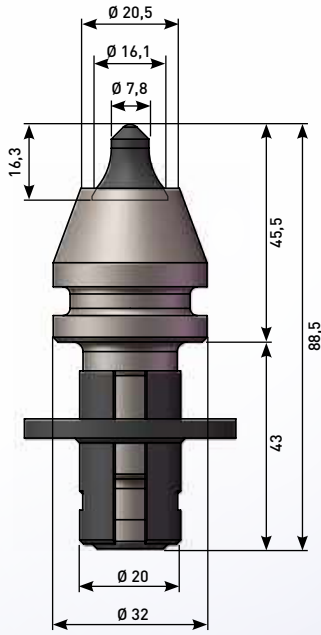

machine size



hardness



packing



PDR4

Picco diametro 20 inserto 16x16.3.
Tool diameter 20 insert 16x16.3.

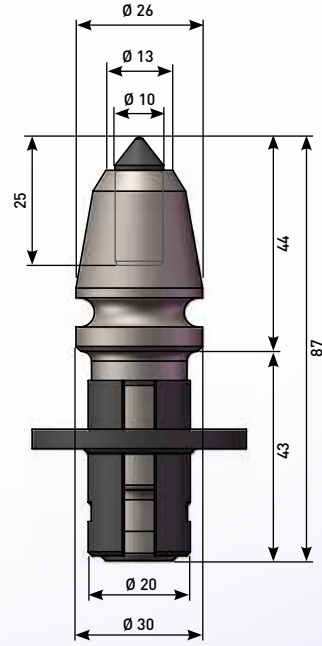

machine size



hardness



packing



PDR10

Picco diametro 20 inserto 10x25.
Tool diameter 20 insert 10x25.

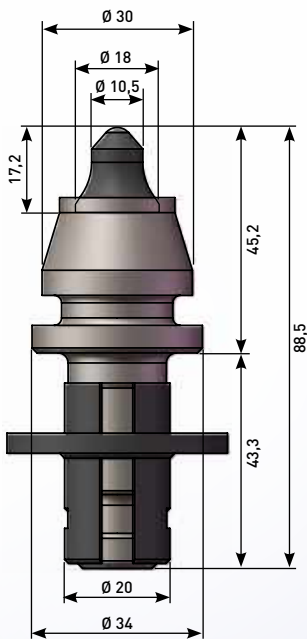

machine size



hardness



packing



PDR6

Picco diametro 20 inserto 18x17.2.
Tool diameter 20 insert 18x17.2.

PDR6-1

Picco diametro 20 inserto 18x17.2 rondella 6mm.
Tool diameter 20 insert 18x17.2 increased washer 6mm.

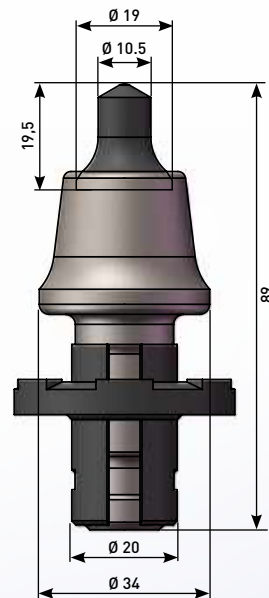

machine size



hardness



packing



PDR6L

Picco diametro 20 inserto 19x19.5 rondella maggiorata.
Tool diameter 20 insert 19x19.5 oversized washer.

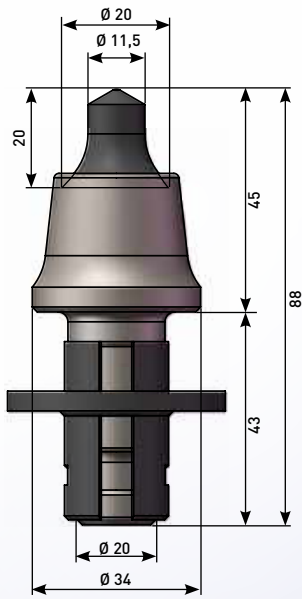

machine size



hardness

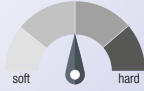

packing



PDR7

Picco diametro 20 inserto 20x20.
Tool diameter 20 insert 20x20.

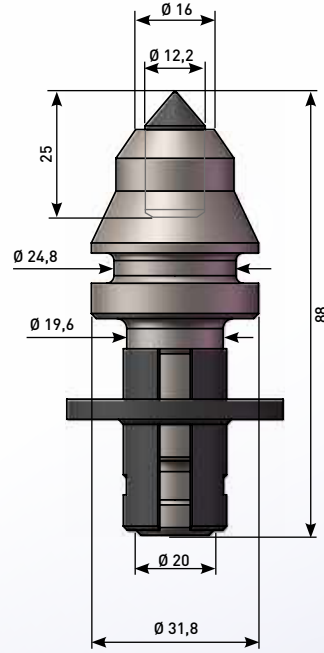

machine size



hardness

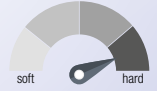

packing



PDR13

picco diametro 20 inserto 12.2x25.
tool diameter 20 insert 12.2x25.

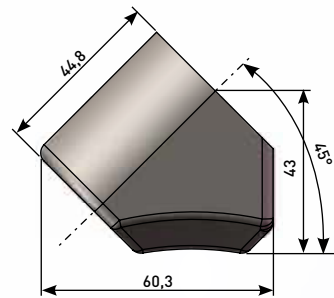
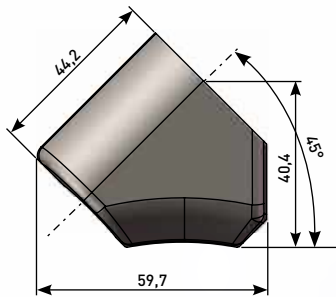

machine size



hardness



packing



PDB20

Supporto diametro 120.
Toolholder diameter 20.

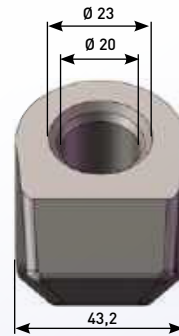

machine size



hardness



packing



PDB20HD

Supporto diametro 20 rinforzato.
Toolholder diameter 20 HD.

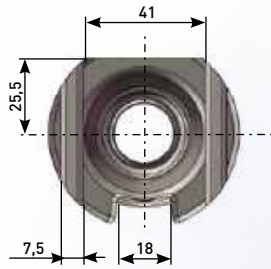
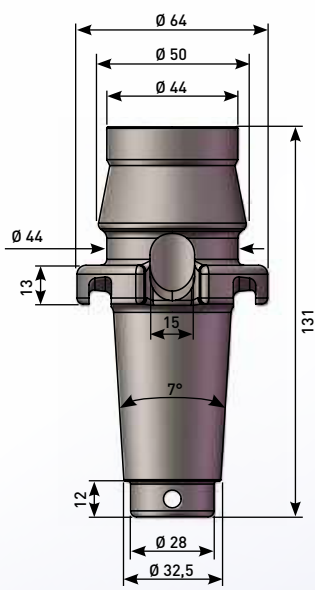

PDB4559

Supporto diametro 19.8 tipo Cat/Bitelli
toolholder diameter 19.8 type Cat/Bitelli



- Fornitura completa di suola metallica
- **NOTA: Realizzabili anche in misure differenti**

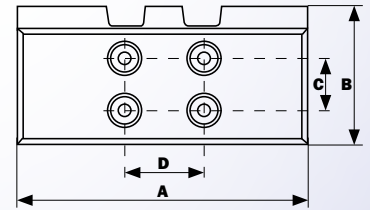

- Complete supply of metal soil
- **NOTE: Available also in different sizes**

Dimensioni mm / Dimensions mm			
A	B	C	D
225	112	52	86
260	112	52	86
300	140	52	86
300	140	57	88,9

PATTINO sliding block

In poliuretano ad alta resistenza all'abrasione.
In polyurethane to high abrasion resistance.

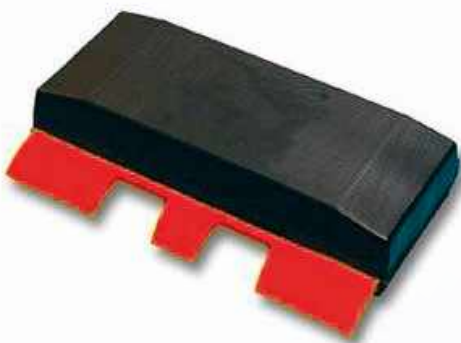

Sovrapattino in poliuretano
Polyurethane pad

Fori già esistenti (da forare se non presenti)
Existing holes (to drill if not present)

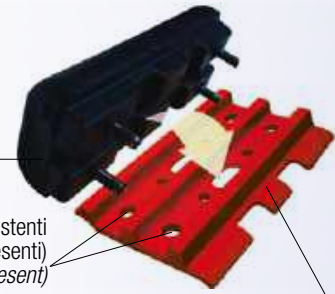

Vostra piastra esistente (non inclusa nella fornitura)
Your existing plate (not included in the supply)

Misura mm Dimension mm	Interasse fori center to center
260	190x52
300	228x57

- 4 fori di fissaggio su Vs. piastra esistente
- Viene sostituito unicamente il pattino mentre la piastra rimane fissa al cingolo
- **NOTA: Realizzabili anche in misure differenti**

SOVRAPATTINO pad

In poliuretano ad alta resistenza all'abrasione e costi manutenzione contenuti.
In polyurethane with high abrasion resistance and low maintenance costs.

- 4 fixin holes on your existing plate
- Only the pad is replaced remains fixed to the "track"
- **NOTE: Available also in different sizes**



PROTEZIONI LATERALI
protector skid

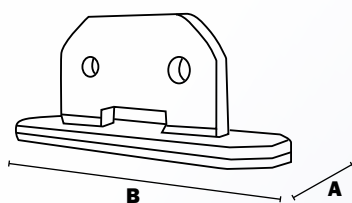
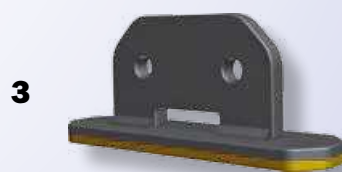
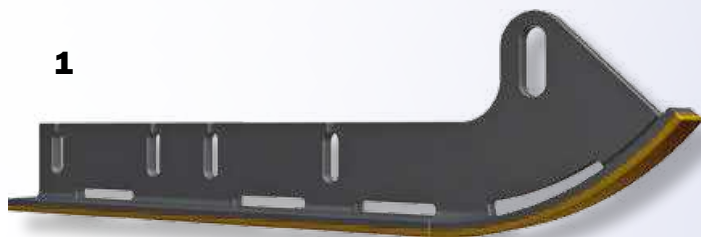

	Riferimento Reference	A mm.	B mm.
1	PDPS155630	50	625
2	PDPS2106074	50	450
3	PDPS2111404	50	200
4	PDPS2129390	40	170

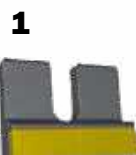

	Riferimento Reference
1	PDSC8838
2	PDSC43408
3	PDSC44638
4	PDSC44639
5	PDSC146459
6	PDSC146515
7	PDSC146461
8	PDSC146460
9	PDSC146456
10	PDSC146457
11	PDSC146458
12	PDSC56731/146469 B100

RASCHIATORI scrapers



STABILIZZAZIONE
soil stabilization

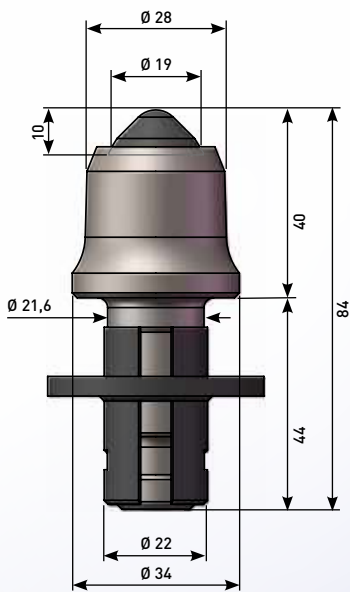

machine size



hardness



packing



PDS6C

Picco diametro 22 inserto 19x10.
Tool diameter 22 insert 19x10.

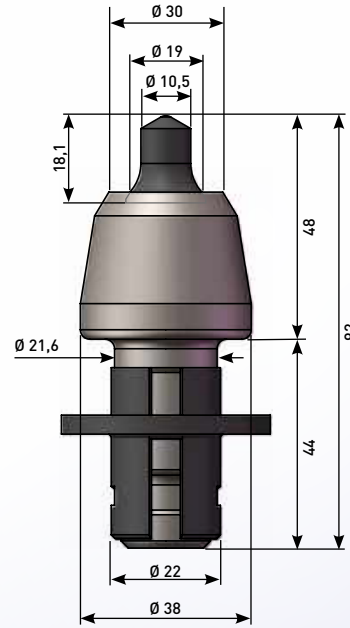

machine size



hardness

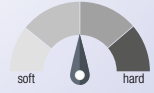

packing



PDS6

Picco diametro 22 inserto 19x18.1.
Tool diameter 22 insert 19x18.1.

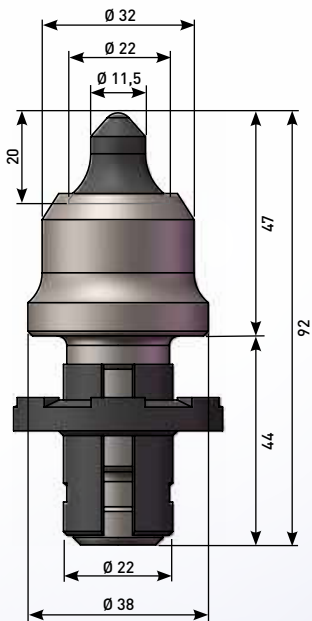

machine size



hardness



packing



PDS8

picco diametro 22 inserto 22x20.
tool diameter 22 insert 22x20.



TESTE FRESANTI
drum cutters

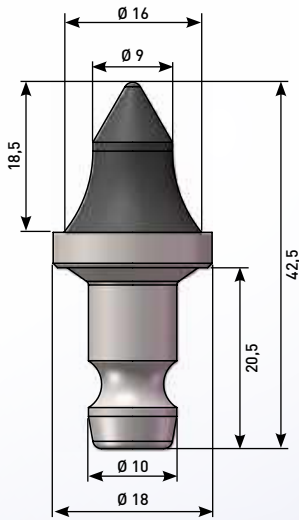

machine size



hardness



packing



PDT1610

Picco diametro 10 inserto 16x18.
Tool diameter 10 insert 16x18.

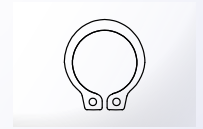
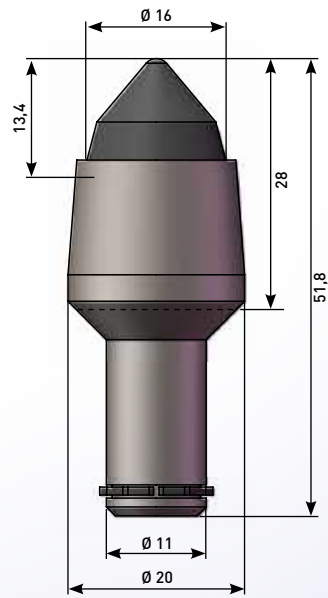

machine size



hardness



packing



PDT1611

Picco diametro 11 inserto 16x13.3.
Tool diameter 11 insert 16x13.3.

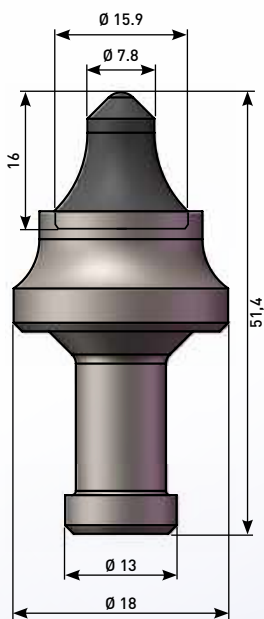

machine size



hardness



packing



PDT1613

Picco diametro 13.
Tool diameter 13.

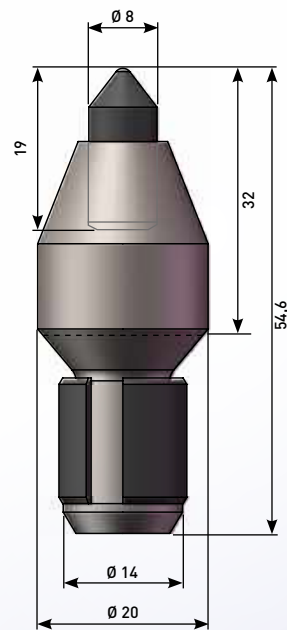

machine size



hardness



packing



PDT814

Picco diametro 14.
Tool diameter 14.

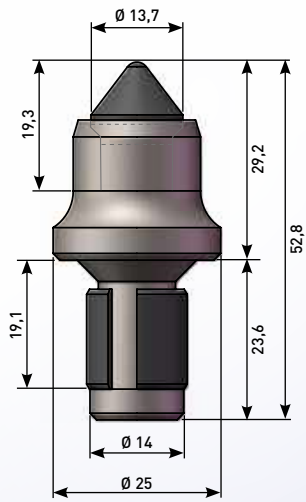

machine size



hardness



packing



PDT1414

Picco diametro 14 inserto 13.7x19.3.
Tool diameter 14 insert 13.7x19.3.

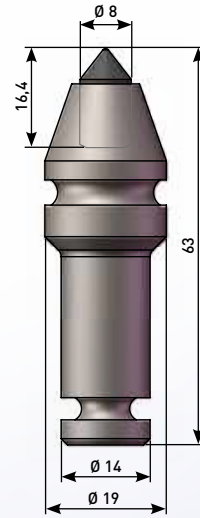

machine size



hardness



packing



PDT814C

Picco diametro 14 inserto 8x16.4.
Tool diameter 14 insert 8x16.4.

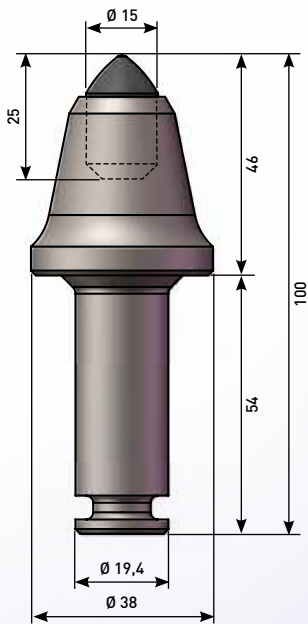

machine size



hardness



packing



PDT1519.4

Picco diametro 19,4 inserto 15x25.
Tool diameter 19,4 insert 15x25.

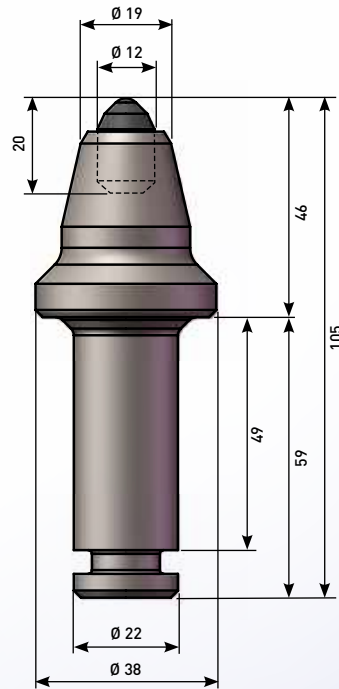

machine size



hardness



packing



PDT1222C

Picco diametro 22 inserto 12x20.
Tool diameter 22 insert 12x20.

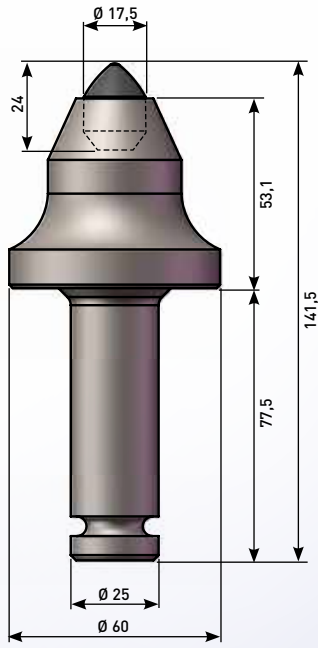

machine size



hardness



packing



PDT17.52560

Picco diametro 25 inserto 17.5x24.
Tool diameter 25 insert 17.5x24.

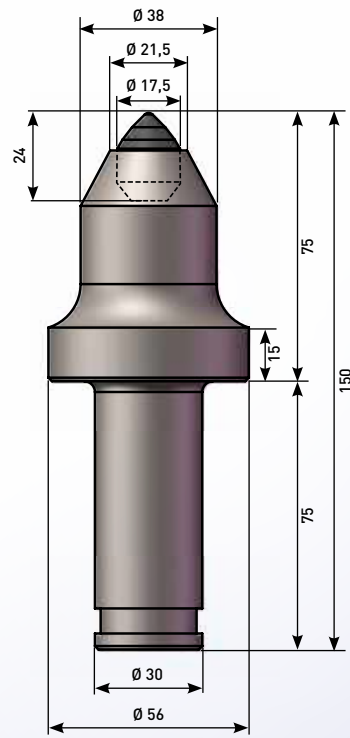

machine size



hardness



packing



PDM17.530

Picco diametro 30 inserto 17.5x24.
Tool diameter 30 insert 17.5x24.

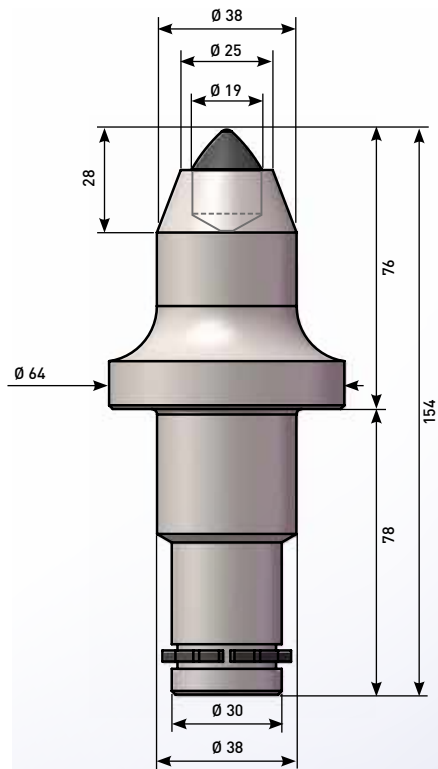

machine size



hardness



packing



PDT1938

Picco diametro 30/38 inserto 19x28.
Tool diameter 30/38 insert 19x28.

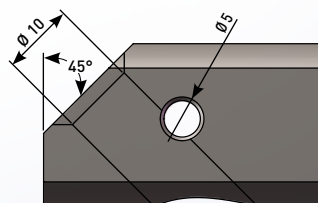
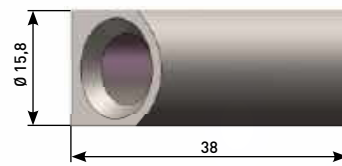

machine size



hardness



packing



PDB10

Supporto diametro 10.
Toolholder diameter 10.

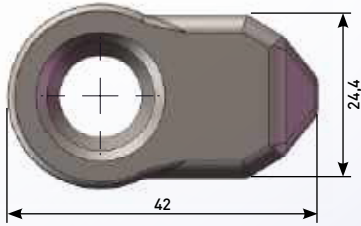
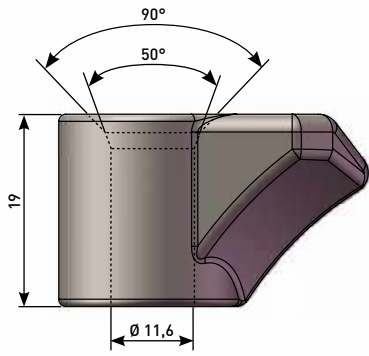

PDB11

Supporto diametro 11.
Toolholder diameter 11.

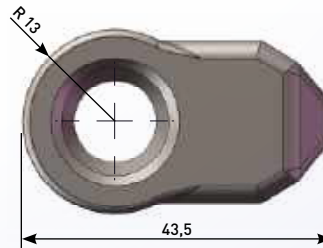
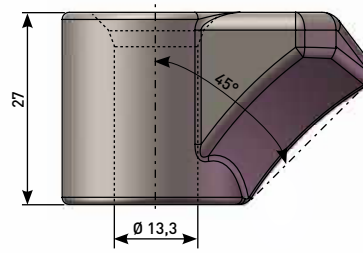

PDB13

Supporto diametro 13.
Toolholder diameter 13.

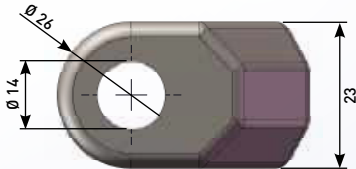
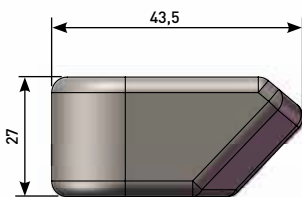

PDB14

Supporto diametro 14.
Toolholder diameter 14.

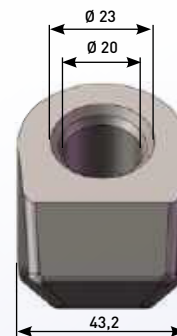
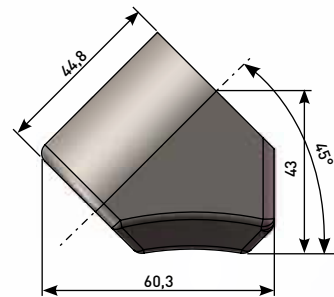

PDB20HD

Supporto diametro 20 rinforzato
Toolholder diameter 20 HD



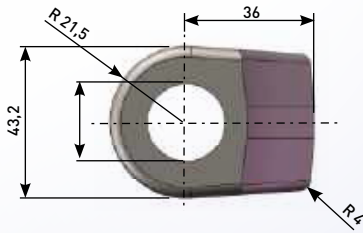
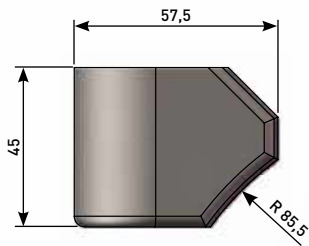

PDB22HD

supporto diametro 22 HD.
toolholder diameter 22 HD.

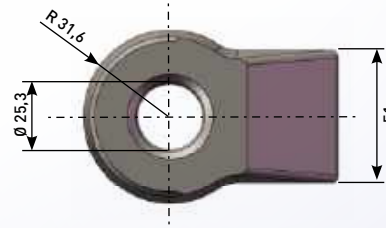
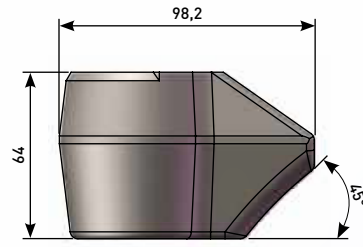

PDB25

Supporto diametro 25.
Toolholder diameter 25.

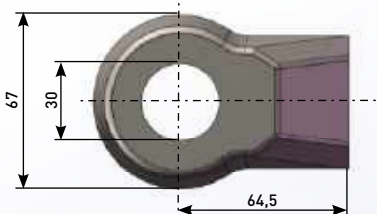
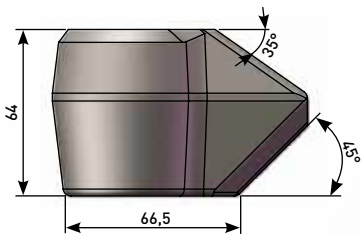

PDB30

Supporto diametro 30.
Toolholder diameter 30.

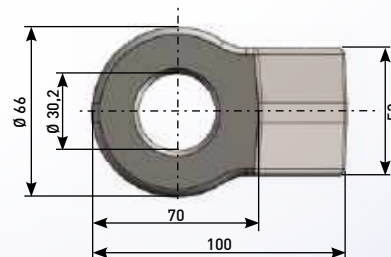
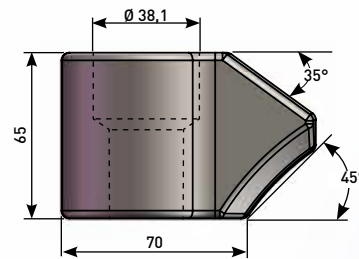

PDB3830

Supporto diametro 30/38.
Toolholder diameter 30/38.





SCAVO
trenching

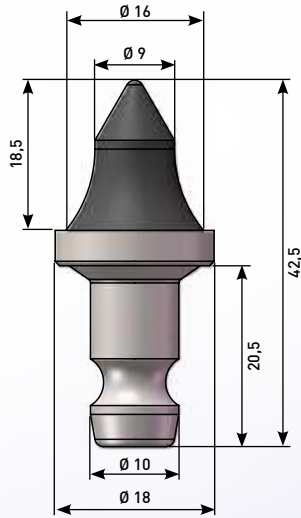

machine size



hardness



packing



PDT1610

Picco diametro 10 inserto 16x18.
Tool diameter 10 insert 16x18.

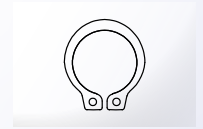
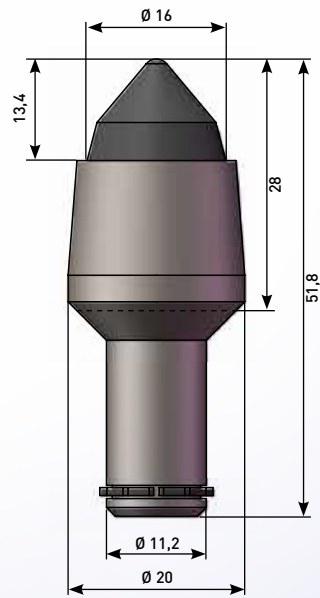

machine size



hardness

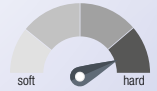

packing



PDT1611

Picco diametro 11 inserto 16x13.4.
Tool diameter 11 insert 16x13.4.

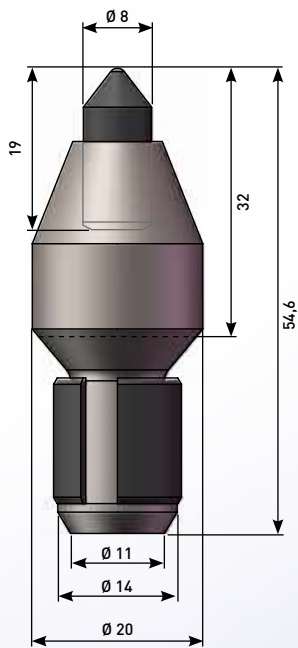

machine size



hardness



packing



PDT814

Picco diametro 14.
Tool diameter 14.

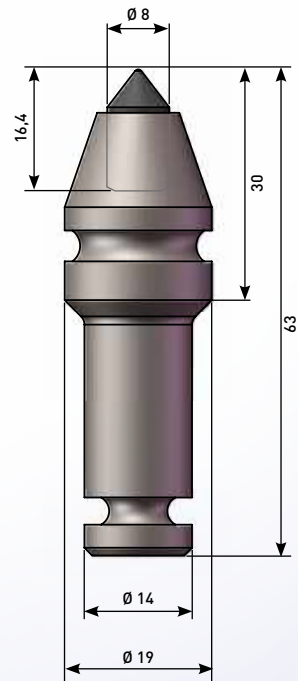

machine size



hardness

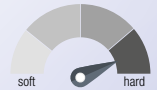

packing



PDT814C

Picco diametro 14 inserto 8x16.4.
Tool diameter 14 insert 8x16.4.

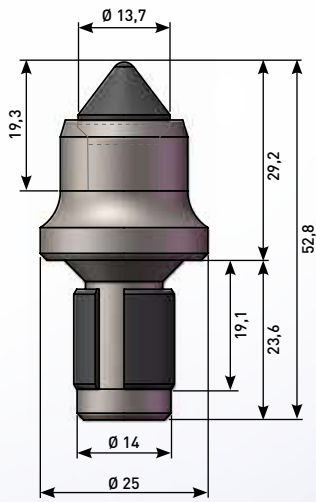

machine size



hardness



packing



PDT1414

Picco diametro 14 inserto 13.7x19.3.
Tool diameter 14 insert 13.7x19.3.

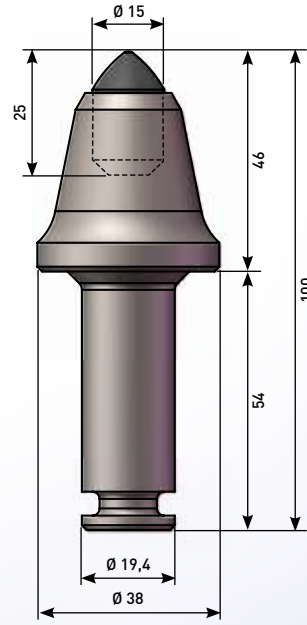

machine size



hardness



packing



PDT1519.4

Picco diametro 20 inserto 15x25.
Tool diameter 20 insert 15x25.

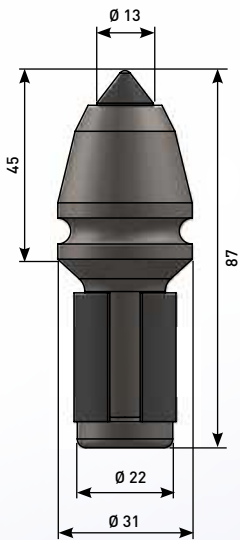

machine size



hardness



packing



PDT1322

Picco diametro 22 inserto 13x25.
Tool diameter 22 insert 13x25.

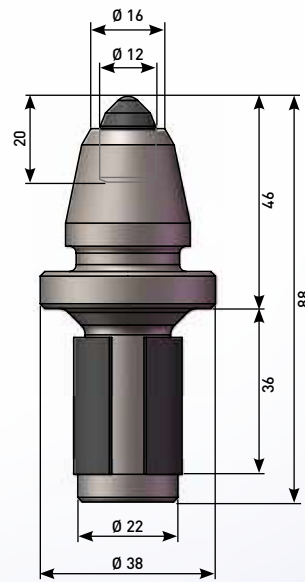

machine size



hardness



packing



PDT1222

Picco diametro 22 inserto 12x20.
Tool diameter 22 insert 12x20.

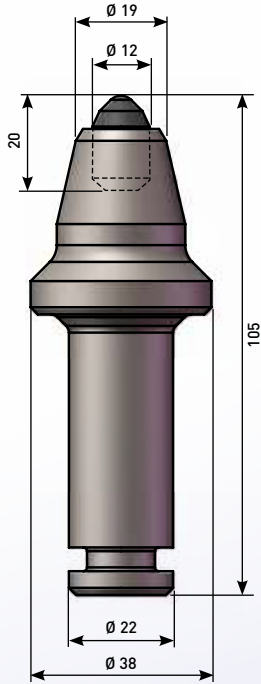

machine size



hardness



packing



PDT1222C

Picco diametro 22 inserto 12x20.
Tool diameter 22 insert 12x20.

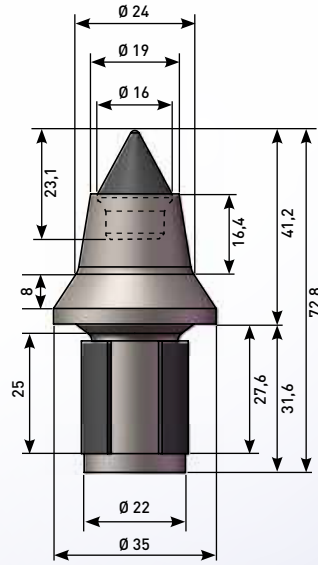

machine size



hardness



packing



PDT1622

Picco diametro 22 inserto 16x23.1.
Tool diameter 22 insert 16x23.1.

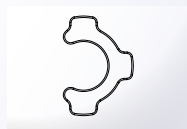
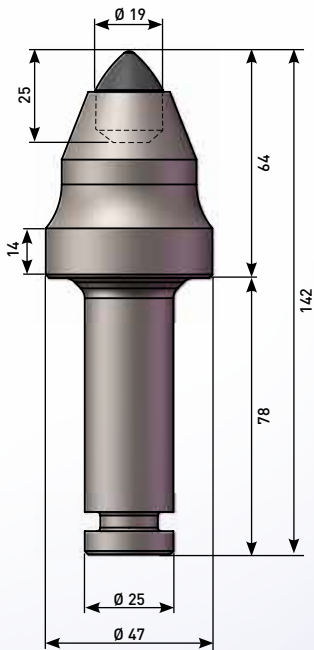

machine size



hardness



packing



PDT1925

Picco diametro 25 inserto 19x25.
Tool diameter 25 insert 19x25.

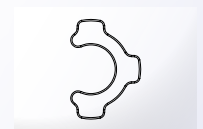
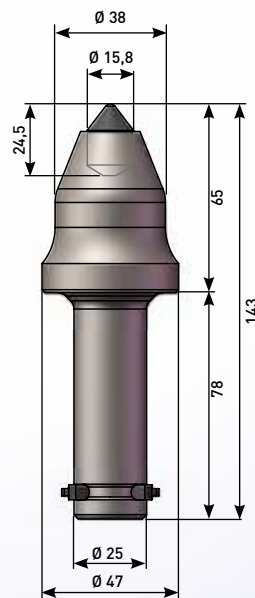

machine size



hardness



packing



PDT1625

Picco diametro 25 inserto 15.8x24.5.
Tool diameter 25 insert 15.8x24.5.



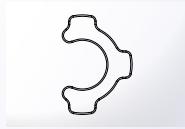
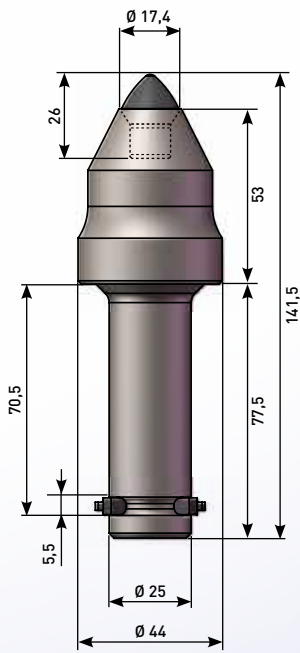

machine size



hardness



packing



PDT17.525

Picco diametro 25 inserto 17.4x26.
Tool diameter 25 insert 17.4x26.

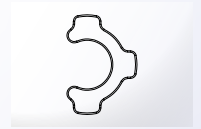
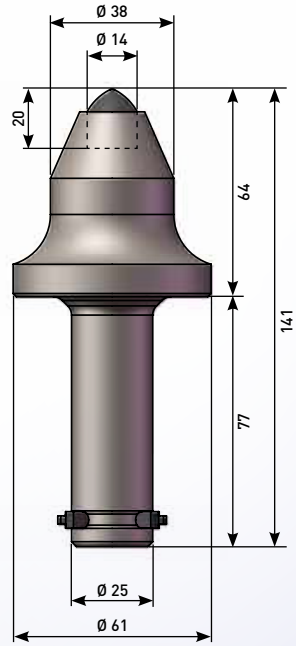

machine size



hardness



packing



PDT1425

Picco diametro 25 inserto 14x20.
Tool diameter 25 insert 14x20.

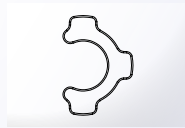
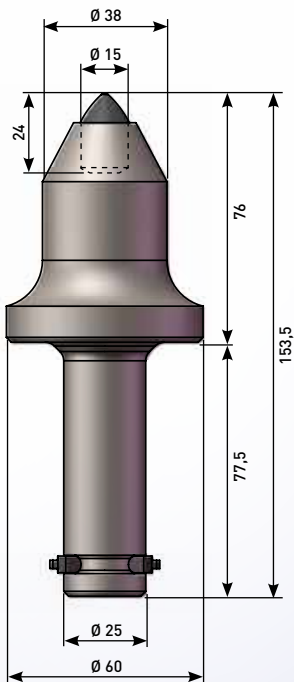

machine size



hardness



packing



PDT152560

Picco diametro 25 inserto 15x24.
Tool diameter 25 insert 15x24.

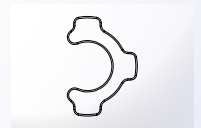
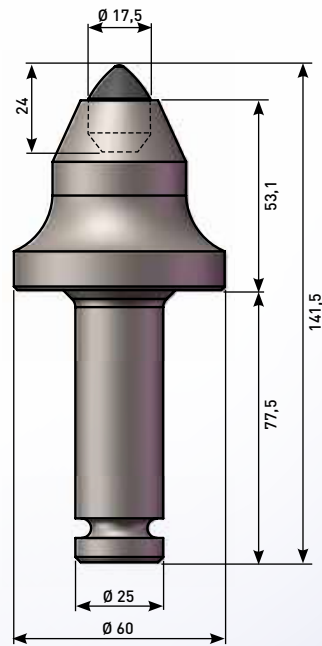

machine size



hardness



packing



PDT17.52560

Picco diametro 25 inserto 17.5x24.
Tool diameter 25 insert 17.5x24.

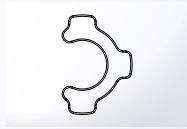
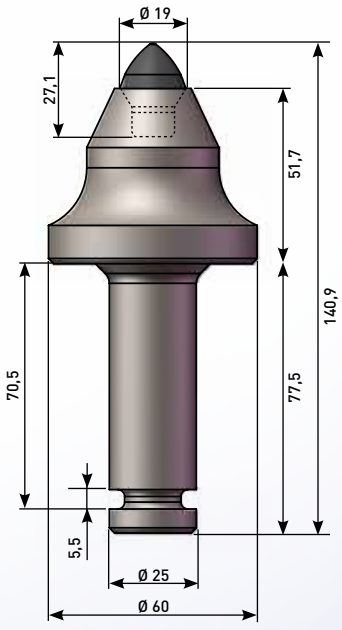

machine size



hardness



packing



PDT192560

Picco diametro 25 inserto 19x27.1.
Tool diameter 25 insert 119x27.1.

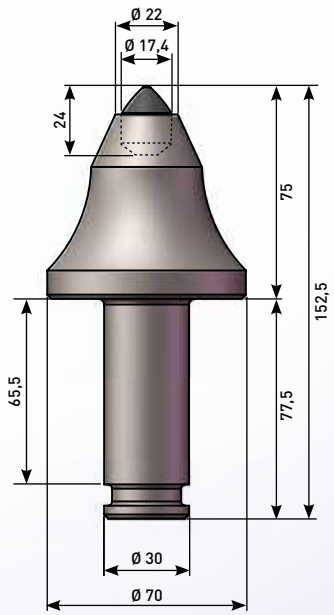

machine size



hardness



packing



PDT173070

Picco diametro 30 inserto 17.5x24.
Tool diameter 30 insert 17.5x24.

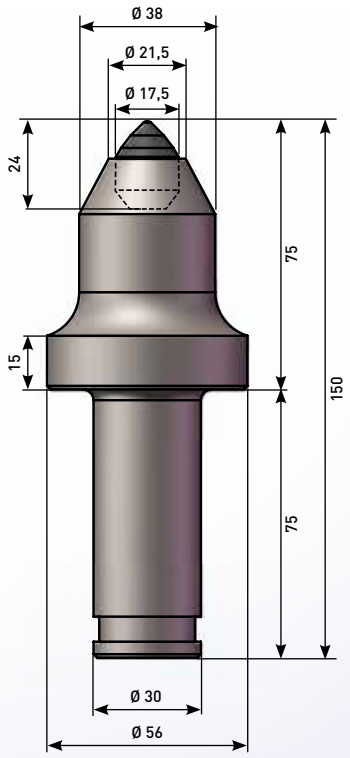

machine size



hardness



packing



PDM17.530

Picco diametro 30 inserto 17.5x24.
Tool diameter 30 insert 17.5x24.

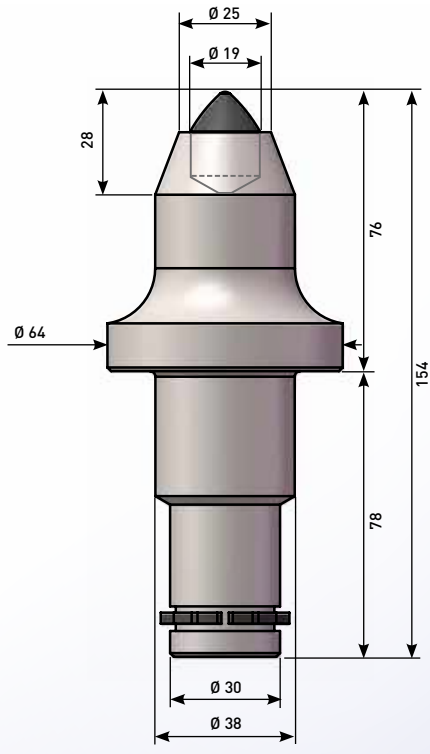

machine size



hardness



packing



PDT1938

Picco diametro 30/38 inserto 19x28.
Tool diameter 30/38 insert 19x28.

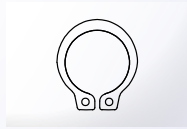
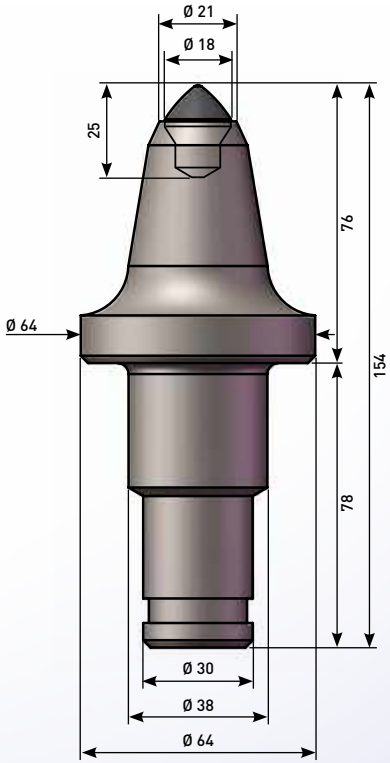

machine size



hardness



packing



PDT1838

Picco diametro 30/38 inserto 18x25.
Tool diameter 30/38 insert 18x25.

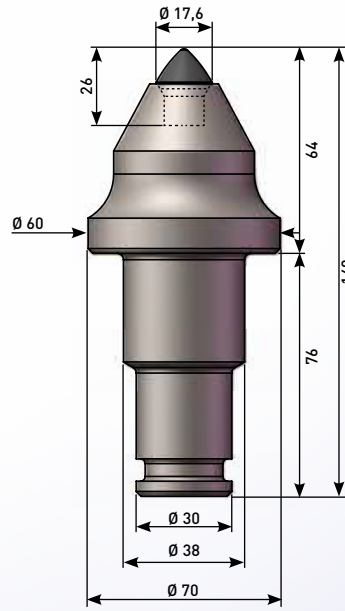

machine size



hardness



packing



PDT17.538C

Picco diametro 30/38 inserto 17x26.
Tool diameter 30/38 insert 17x26.

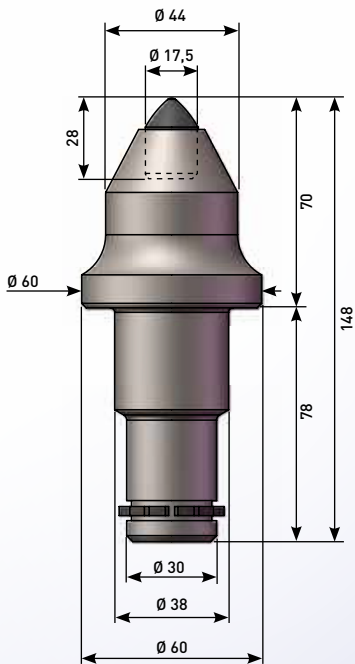

machine size



hardness



packing



PDT17.538

picco diametro 30/38 inserto 17.4x28.5.
Tool diameter 30/38 insert 17.4x28.5.

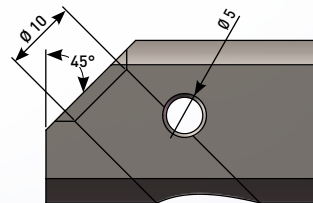
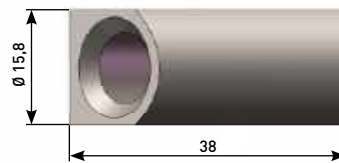

machine size



hardness



packing



PDB10

Supporto diametro 10.
Toolholder diameter 10.



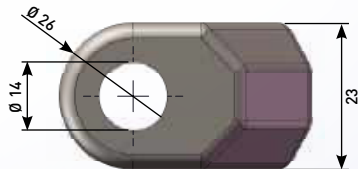
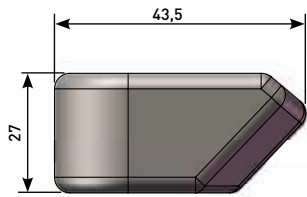

PDB14

Supporto diametro 14.
Toolholder diameter 14.

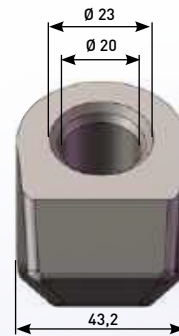
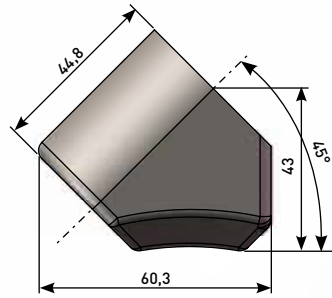

PDB20HD

Supporto diametro 20 rinforzato
Toolholder diameter 20 HD

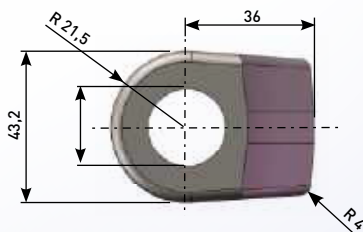
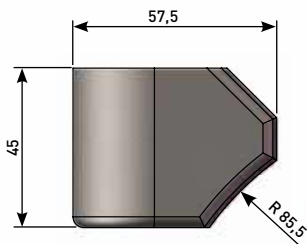

PDB22HD

supporto diametro 22 HD.
toolholder diameter 22 HD.

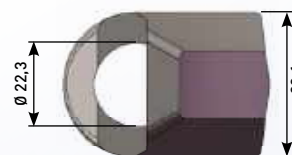
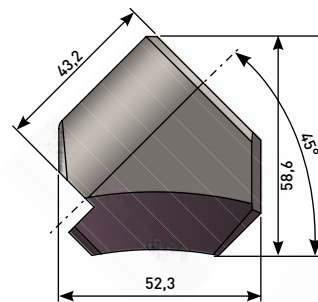

PDB22B

Supporto diametro 22.
Toolholder diameter 22.



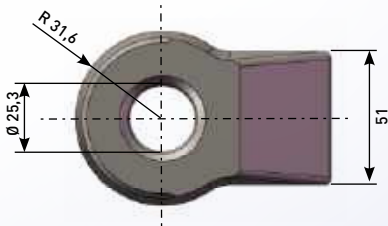
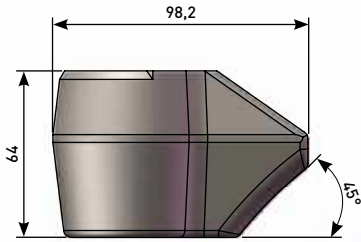

PDB25

Supporto diametro 25.
Toolholder diameter 25.

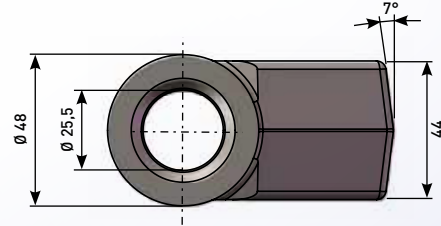
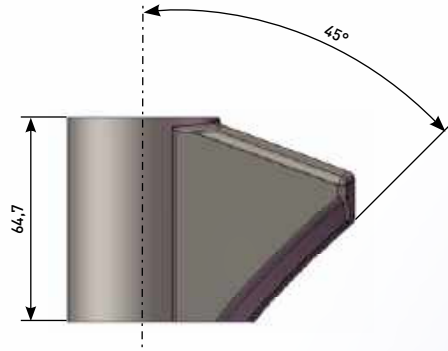

PDB25W

Supporto diametro 25.
Toolholder diameter 25.

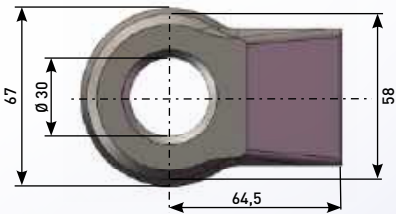
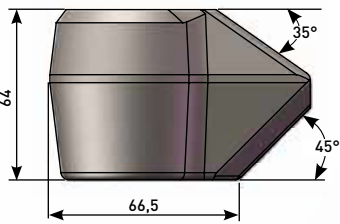

PDB30

Supporto diametro 30.
Toolholder diameter 30.

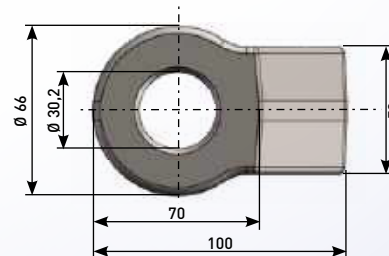
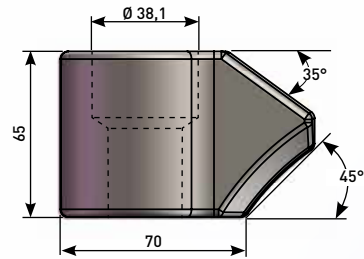

PDB3830

Supporto diametro 30/38.
Toolholder diameter 30/38.





PERFORAZIONE FONDAZIONI
drilling foundation

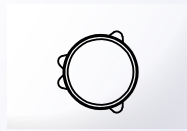
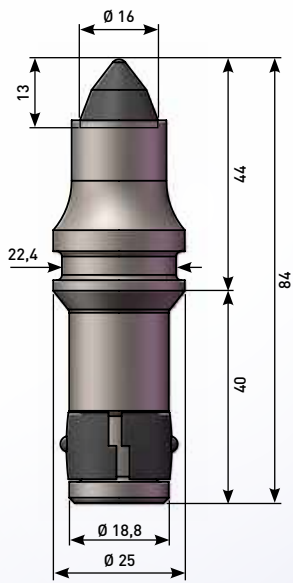

machine size



hardness



packing



PDF1618.8

Picco diametro 18,8 inserto 16x13.
Tool diameter 18,8 insert 16x13.

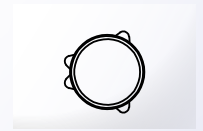
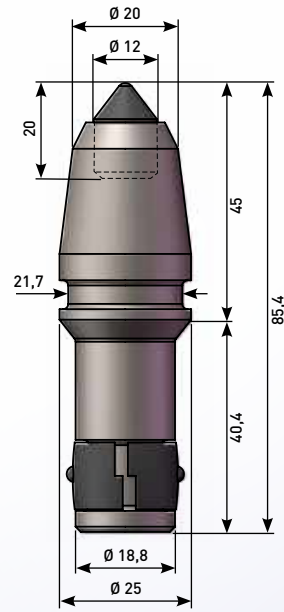

machine size



hardness



packing



PDF1218.8HD

Picco diametro 20 inserto 12x20.
Tool diameter 20 insert 12x20.

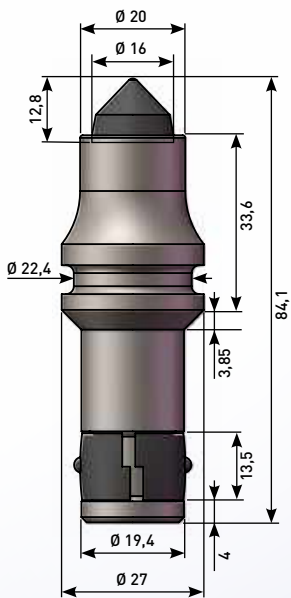

machine size



hardness



packing



PDF1619.4

Picco diametro 19,4 inserto 16x19,4.
Tool diameter 19,4 insert 16x19,4.

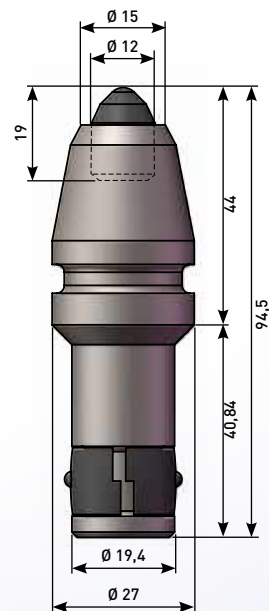

machine size



hardness

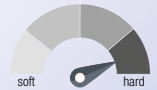

packing



PDF1219.4

Picco diametro 20 inserto 12x19,4.
Tool diameter 20 insert 12x19,4.



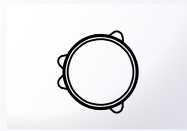
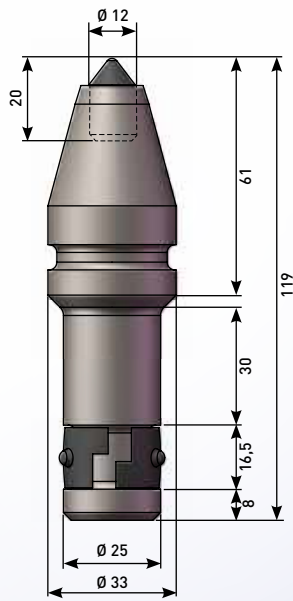

machine size



hardness



packing



PDF1225

Picco diametro 25 inserto 12x20.
Tool diameter 25 insert 12x20.

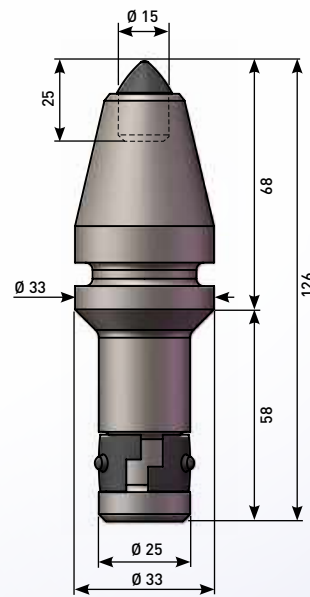

machine size



hardness



packing



PDF1525

Picco diametro 25 inserto 15x25.
Tool diameter 25 insert 15x25.

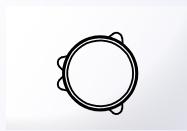
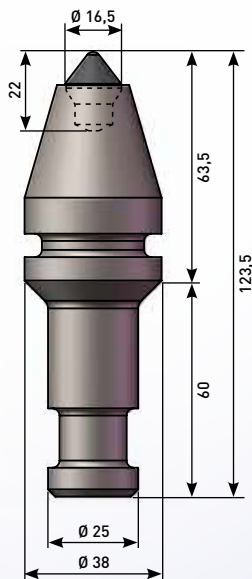

machine size



hardness



packing



PDF16.525

Picco diametro 25 inserto 16,5x22.
Tool diameter 25 insert 16,5x22.

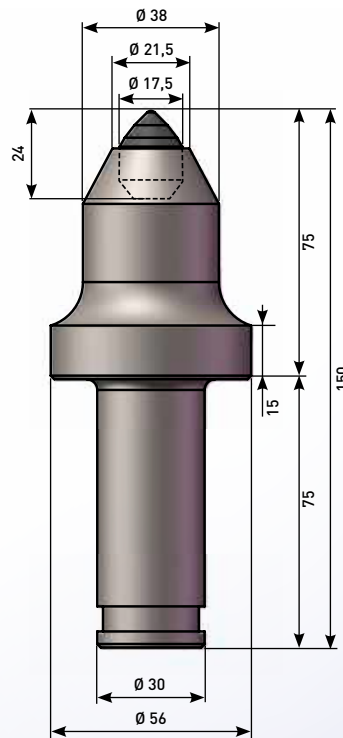

machine size



hardness



packing



PDM17.530

Picco diametro 30 inserto 17,5x24.
Tool diameter 30 insert 17.5x24.

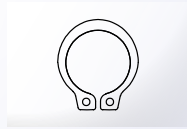
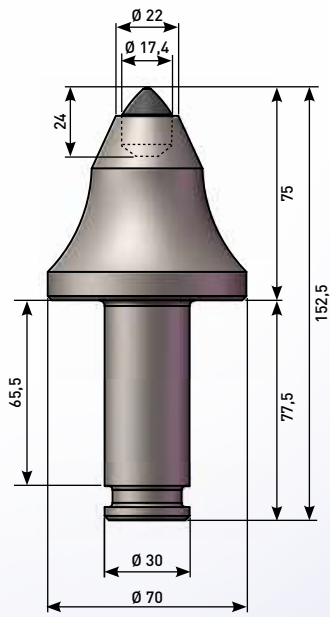

machine size



hardness



packing



PDT173070

Picco diametro 30 inserto 17.5x24.
Tool diameter 30 insert 17.5x24.

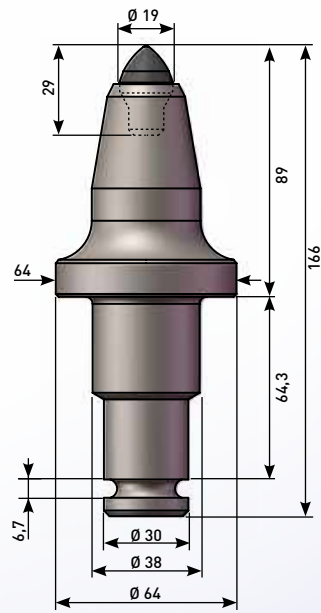

machine size



hardness



packing



PDT193875C

Picco diametro 30/38 inserto 19x29.
Tool diameter 30/38 insert 19x29.

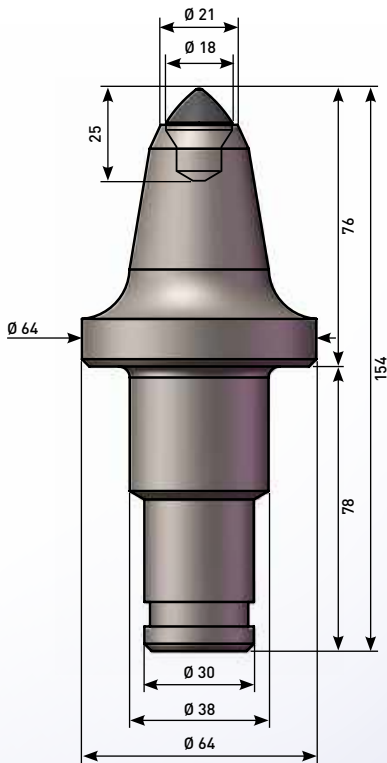

machine size



hardness



packing



PDT1838

Picco diametro 30/38 inserto 18x25.
Tool diameter 30/38 insert 18x25.

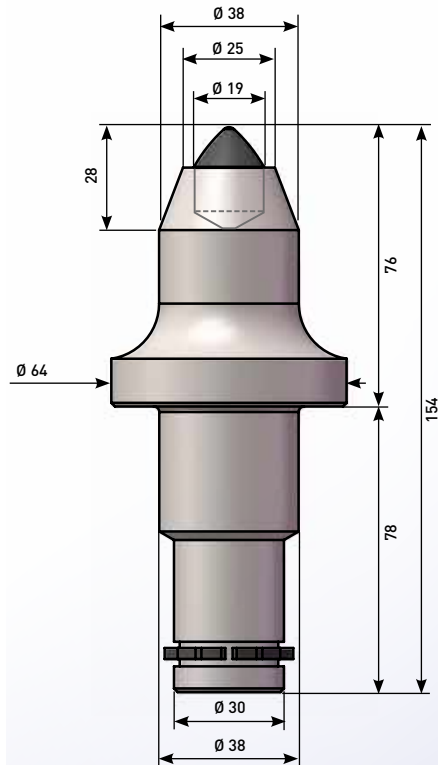

machine size



hardness



packing



PDT1938

Picco diametro 30/38 inserto 19x28.
Tool diameter 30/38 insert 19x28.

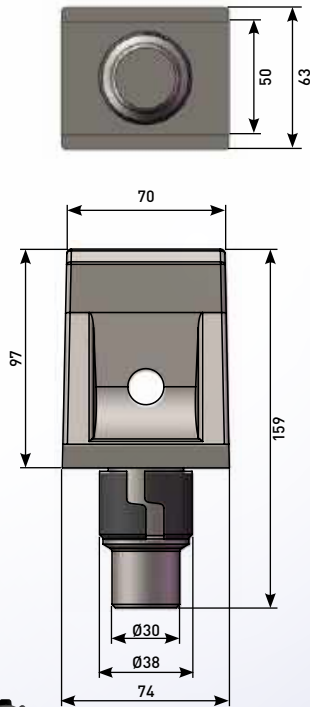

PDF69

Dente diametro 30/38.
Teeth diameter 30/38.

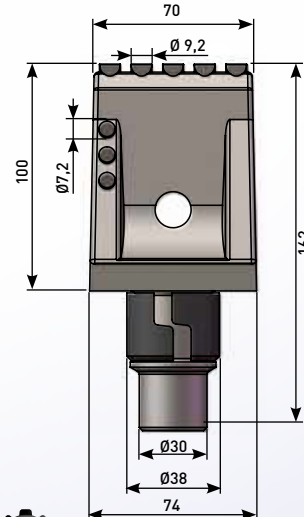
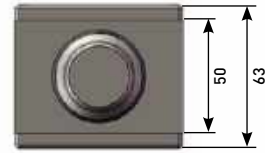

PDF162

Dente diametro 30/38 inserto 9.2.
Teeth diameter 30/38 insert 9.2.

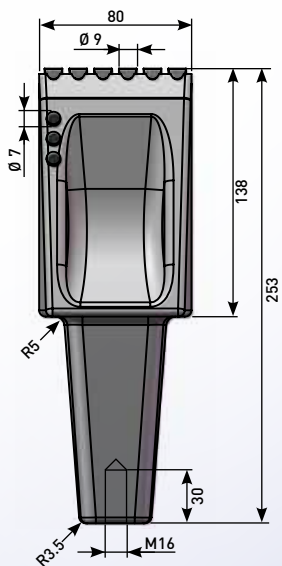
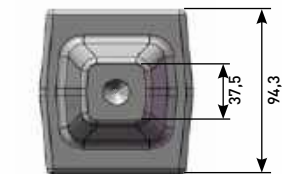

PDF317

Dente piatto inserti da 9.
Flat teeth tungsten carbide 9.

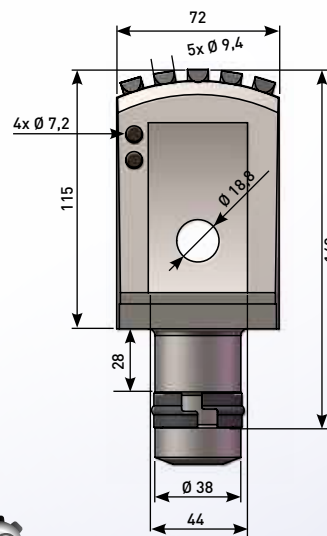
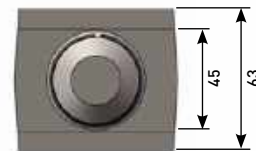

PDF72

Dente diametro 38 inserto 9.4.
Teeth diameter 38 insert 9.4.





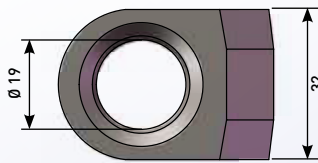
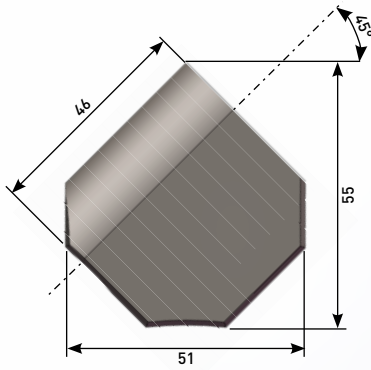

PDB19

Supporto diametro 19.
Toolholder diameter 19.

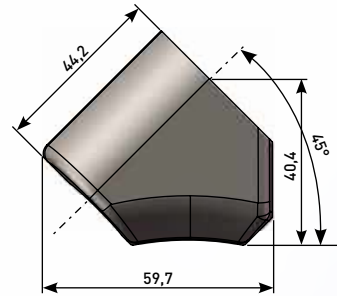

PDB20

Supporto diametro 19.8
Toolholder diameter 19.8

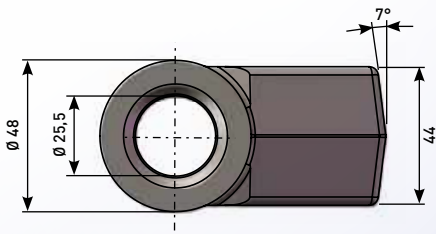
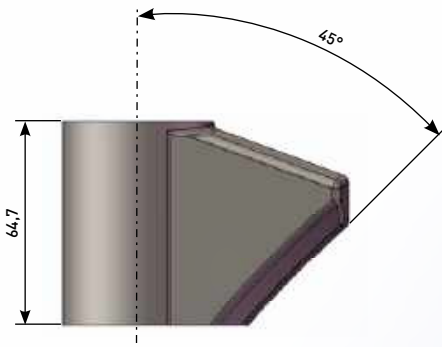

PDB25W

Supporto diametro 25.
Toolholder diameter 25.

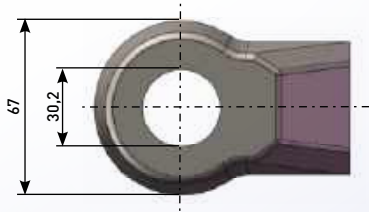
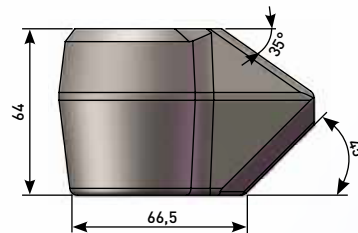

PDB30

Supporto diametro 30.
Toolholder diameter 30.



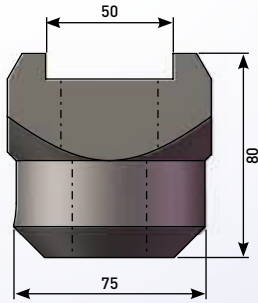
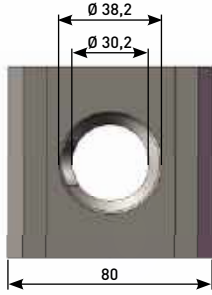

PDB112

Supporto dente diametro 30/38.
Toolholder teeth diameter 30/38.

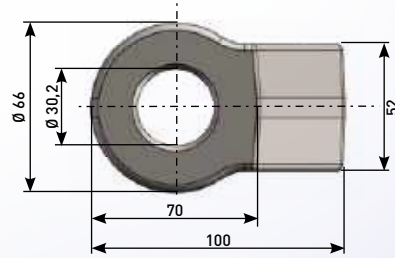
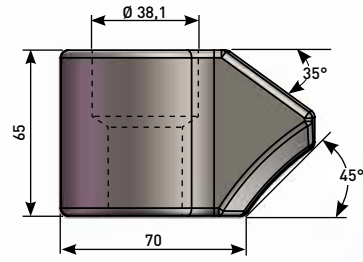

PDB3830

Supporto diametro 30/38.
Toolholder diameter 30/38.

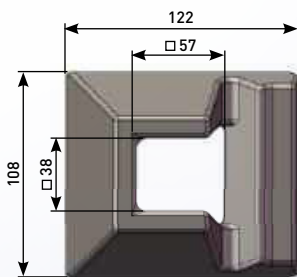
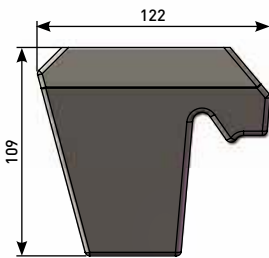

PDB73

Supporto dente piatto.
Toolholder flat teeth.

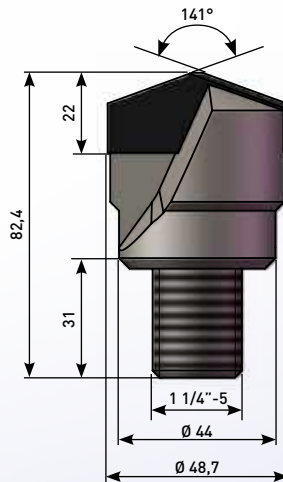
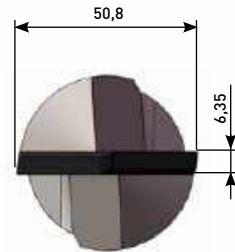

PDPT16

Punta pilota.
Pilot tip.



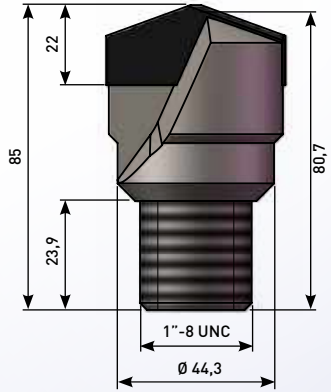
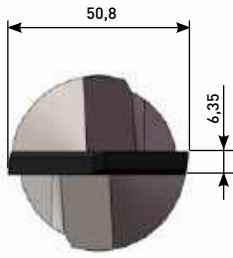

PDPT18

Punta pilota.
Pilot tip.

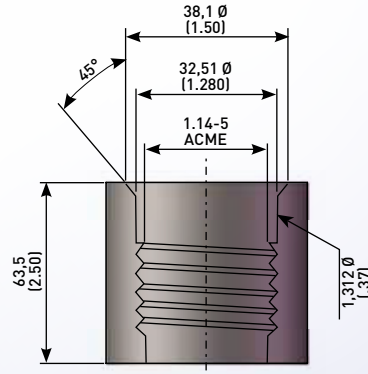
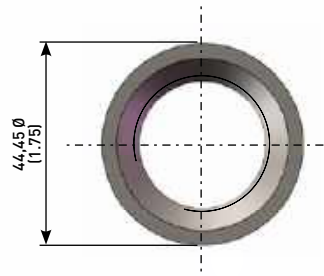

PDPTB18

Portapunta.
Pilot tip tool holder.

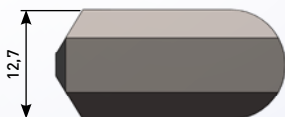
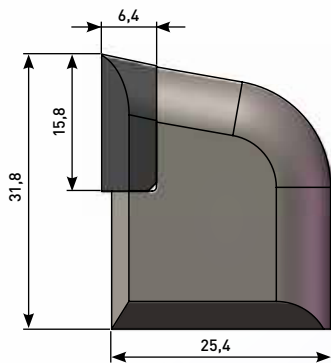

PDFRT1

Allargatore inserto 12x15x6.
Reamer tungsten carbide insert 12x15x6.

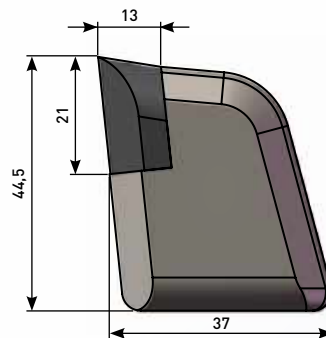

PDFRT2

Allargatore inserto 12x15x6.
Reamer tungsten carbide insert 12x15x6.

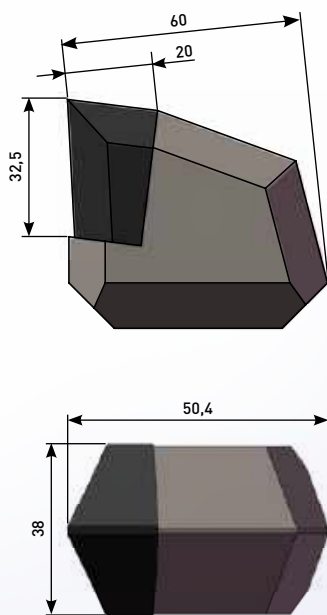

PDF38

Allgatore inserto 38x32,5x20.
Reamer tungsten carbide insert 38x32,5x20.

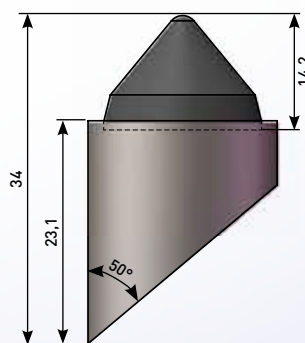

PDFBR1

Alesatore inserto 17.3x14.2.
Reamer tungsten carbide insert 17.3x14.2.

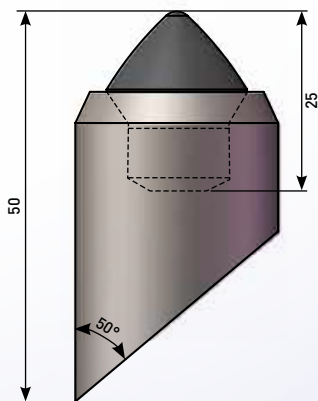
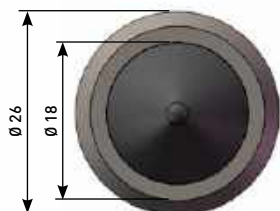

PDFBR3

Alesatore inserto 18x25.
Reamer tungsten carbide insert 18x25.

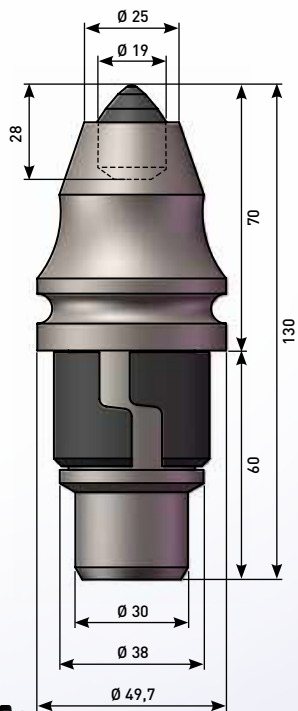

PDF1938

Picco diametro 30/38 inserto da 19x28.
Tool diameter 30/38 insert 19x28.



machine size



hardness



packing

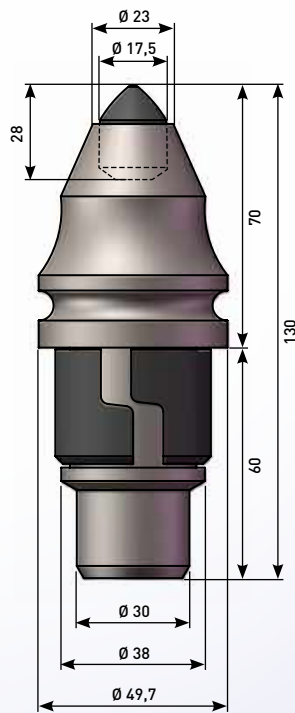

PDF17.538

Picco diametro 30/38 inserto da 17.5x28.
Tool diameter 30/38 insert 17.5x28.



machine size



hardness



packing

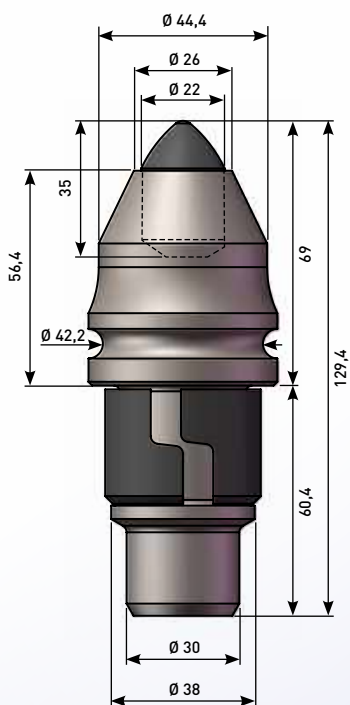

PDF2238

Picco diametro 30/38 inserto da 22x35.
Tool diameter 30/38 insert 22x35.



machine size



hardness



packing

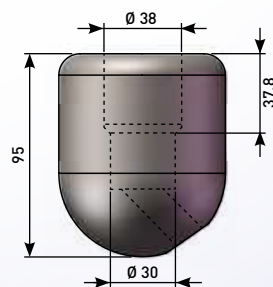
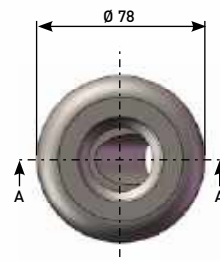

PDB76

Supporto dente diametro 30/38.
Toolholder teeth diameter 30/38.

machine size



hardness

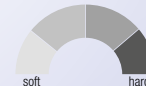

packing





BARRE A SALDARE
welding bars

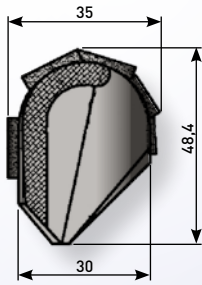
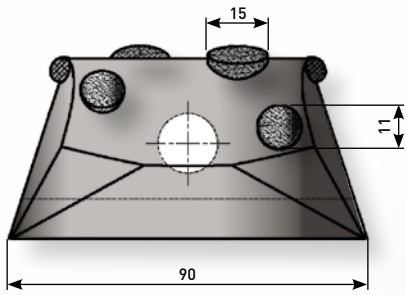

machine size



hardness



packing



PDW01

Barre a saldare.
Welding bar.

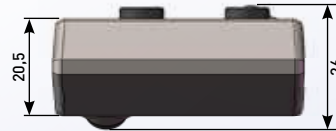
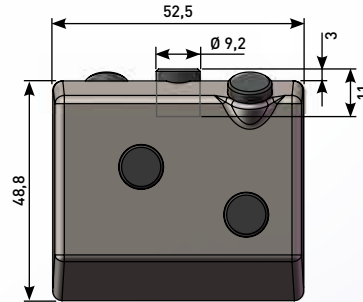
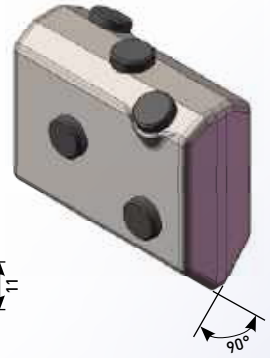

machine size



hardness



packing



PDW10

Barre a saldare.
Welding bar.

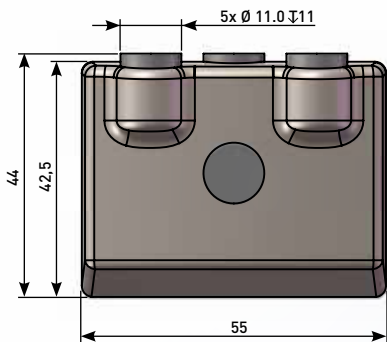

machine size



hardness



packing



PDW13

Barre a saldare.
Welding bar.

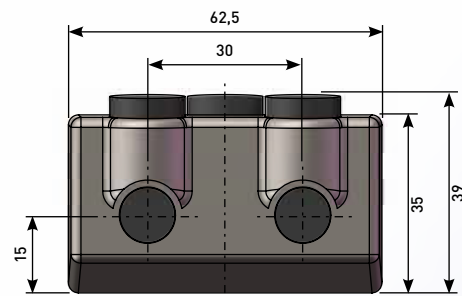

machine size



hardness



packing



PDW32

Barre a saldare.
Welding bar.

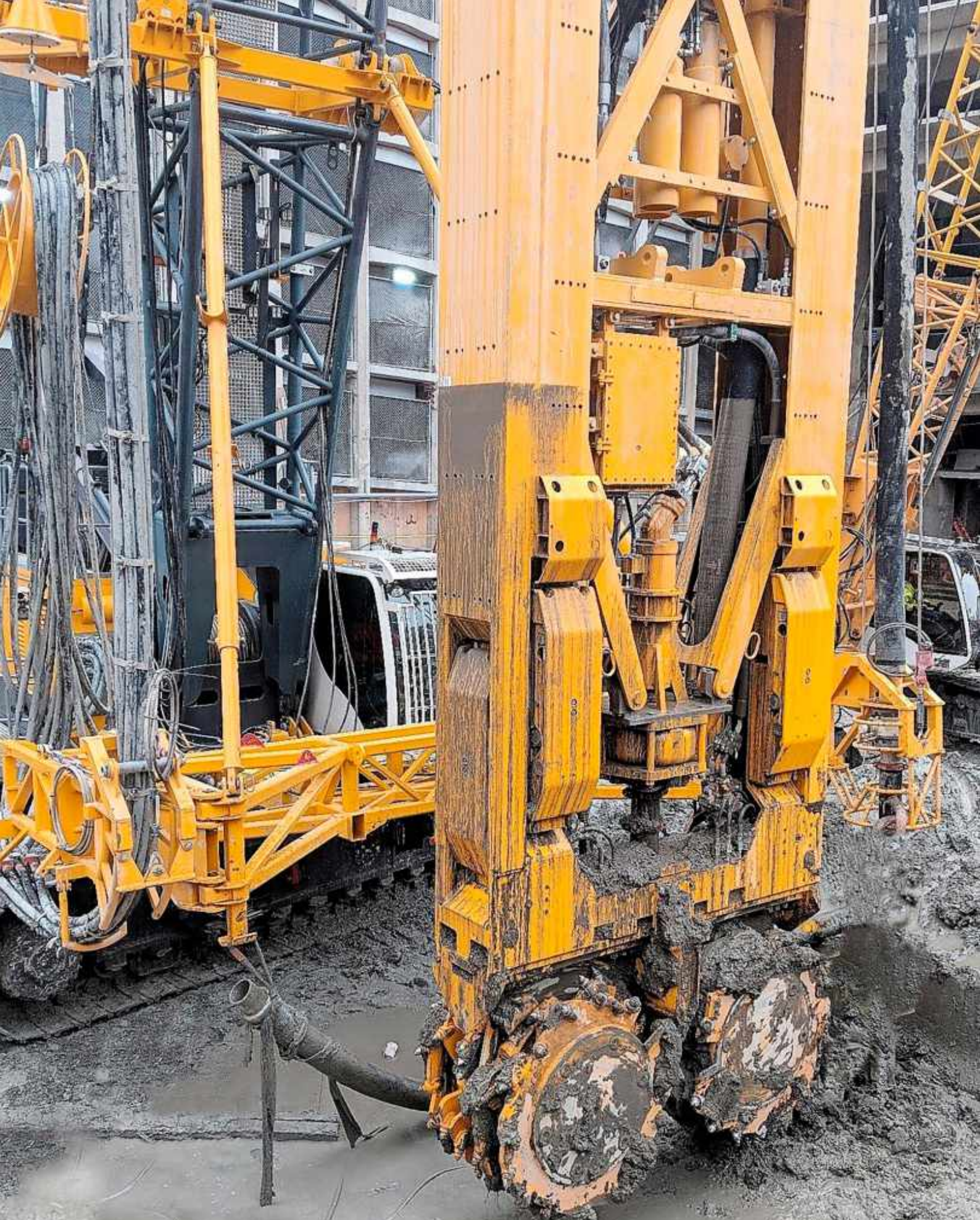

IDROFRESE
hydraulic milling

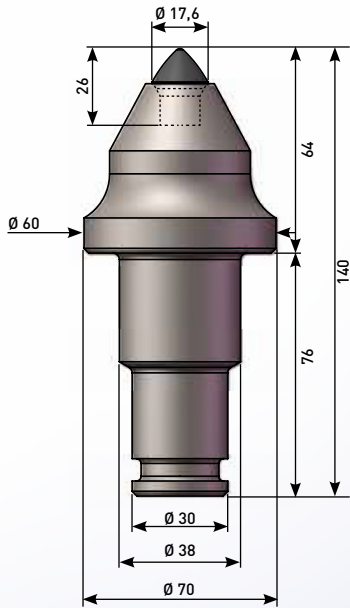

machine size



hardness



packing



PDT17.538C

Picco diametro 30/38 inserto 17x26.
Tool diameter 30/38 insert 17x26.

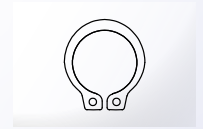
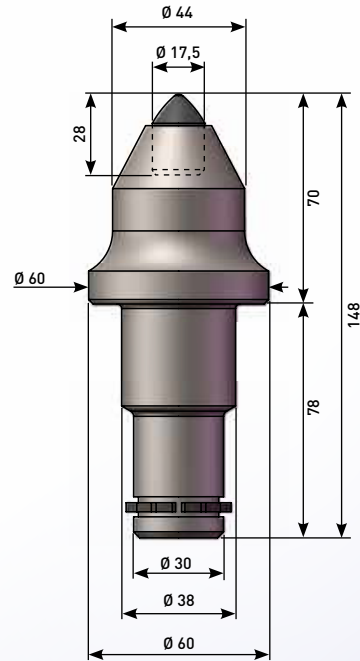

machine size



hardness



packing



PDT17.538

picco diametro 30/38 inserto 17.4x28.5.
Tool diameter 30/38 insert 17.4x28.5.

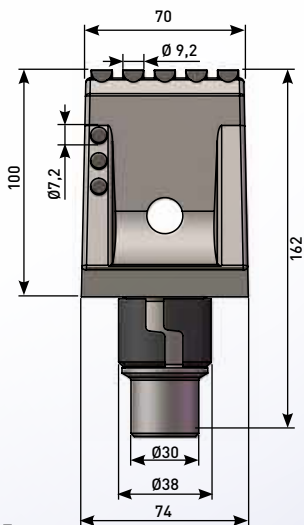
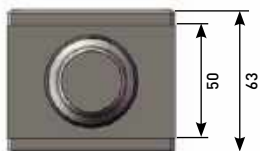

machine size



hardness



packing



PDF162

Dente diametro 30/38 inserto 9.2.
Teeth diameter 30/38 insert 9.2.

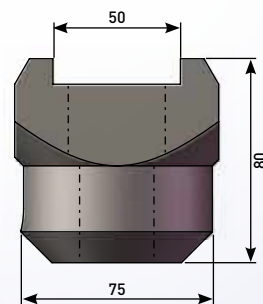
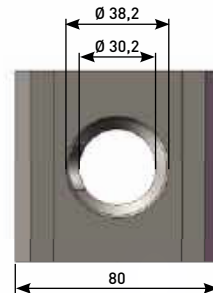

machine size



hardness



packing



PDB112

Supporto dente diametro 30/38.
Toolholder teeth diameter 30/38.



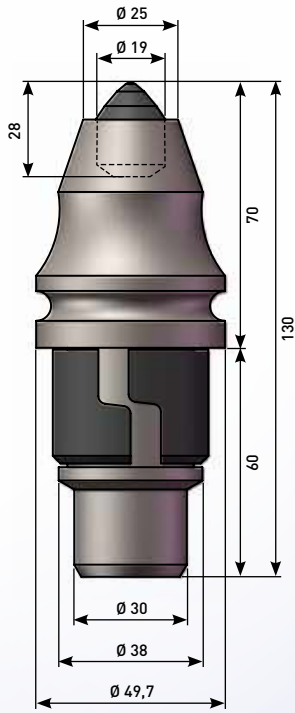

machine size



hardness



packing



PDF1938

Picco diametro 30/38 inserto da 19x28.
Tool diameter 30/38 insert 19x28.

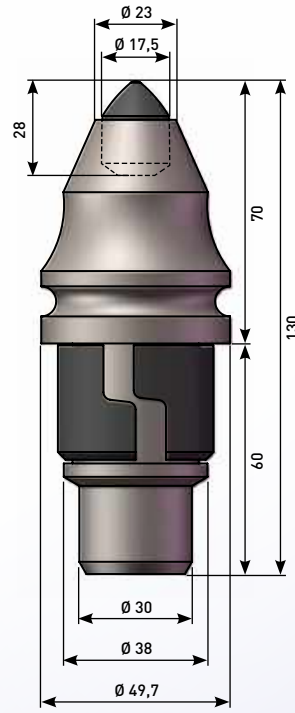

machine size



hardness



packing



PDF17.538

Picco diametro 30/38 inserto da 17.5x28.
Tool diameter 30/38 insert 17.5x28.

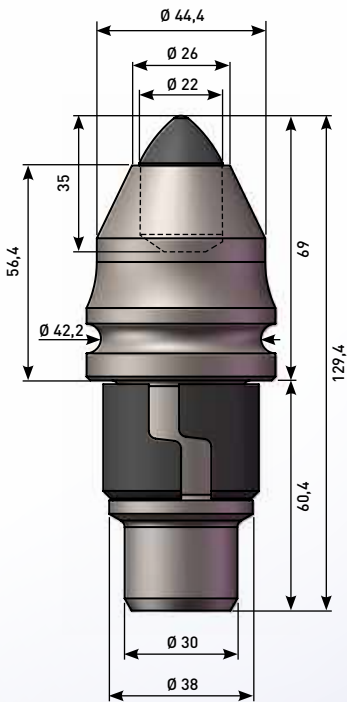

machine size



hardness



packing



PDF2238

Picco diametro 30/38 inserto da 22x35.
Tool diameter 30/38 insert 22x35.

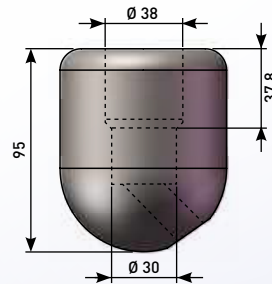
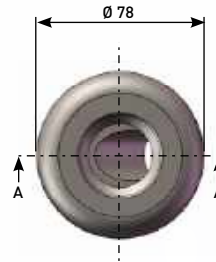

machine size



hardness



packing



PDB76

Supporto dente diametro 30/38.
Toolholder teeth diameter 30/38.



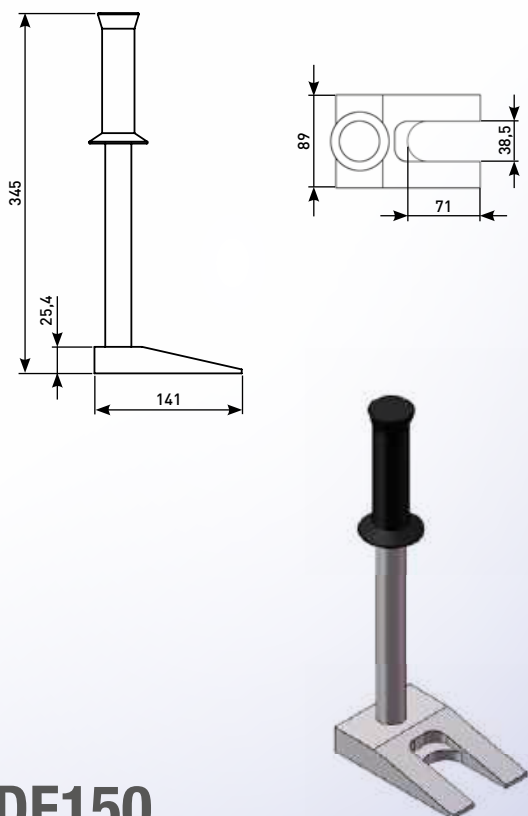

PDE150

Estrattore a forcella gambo 30/38.
Tool diameter 30/38 insert 17x26.

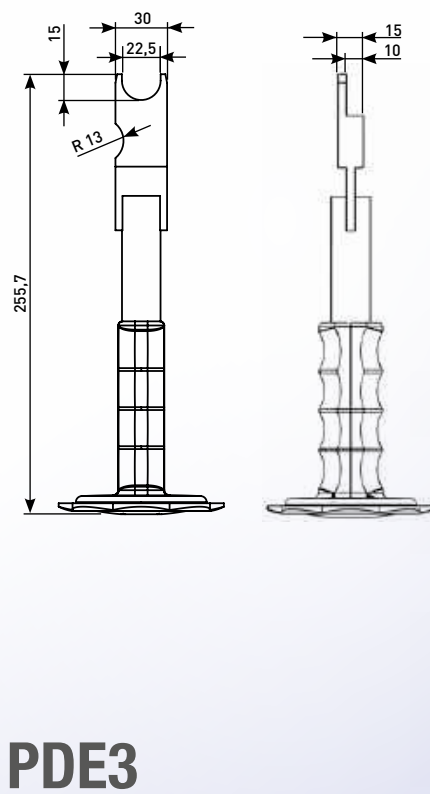

PDE3

Estrattore gambo 30/38.
Tool diameter 30/38 insert 17.4x28.5.

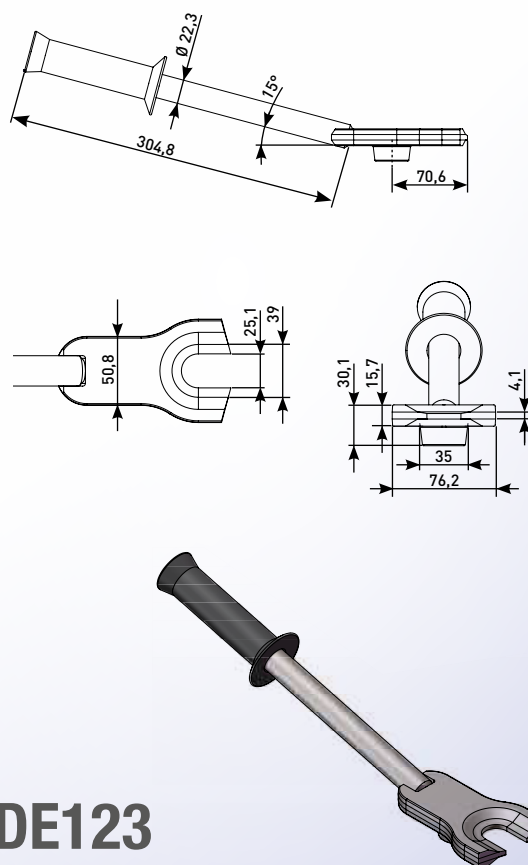

PDE123

Estrattore a forcella gambo 22.
Teeth diameter 30/38 insert 9.2.

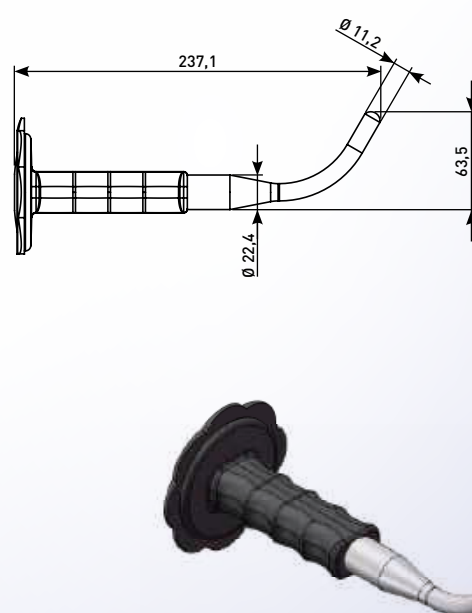

PDE2

Estrattore a forcella gambo 22.
Toolholder teeth diameter 30/38.

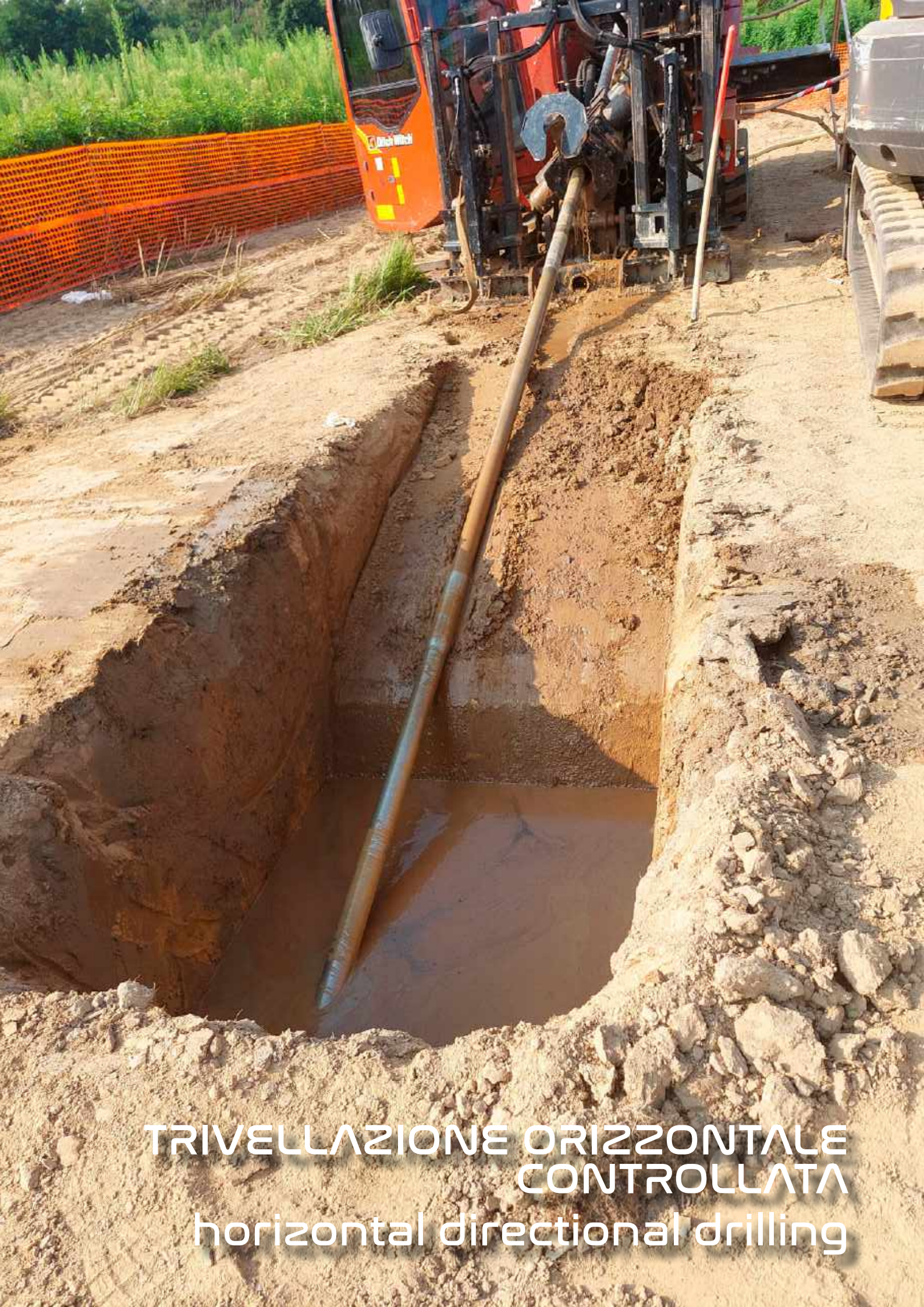

TRIVELLAZIONE ORIZZONTALE
CONTROLLATA
horizontal directional drilling

processo produttivo/production process

Grazie ai rigorosi controlli effettuati su tutta la filiera di produzione: dal materiale grezzo al trattamento termico, dalle lavorazioni alle macchine CNC ai procedimenti termochimici dei trattamenti dei filetti, siamo in grado di garantire un prodotto eccellente con ottime e performanti qualità'.
Le aste Power Drill sono compatibili con le principali trivelle presenti sul mercato.

*Thanks to the meticulous checks made on the whole production chain: from the rough material to the thermal treatment, from the process through CNC machines to the thermal chemical process of the thread's treatment, we are able to guarantee a product of excellence with a performing really good quality.
Power Drill rods are compatible with the main drilling machines on the market.*

ASTE FORGIATE IN UN PEZZO UNICO FORGED-ONE-PIECE DRILL PIPE

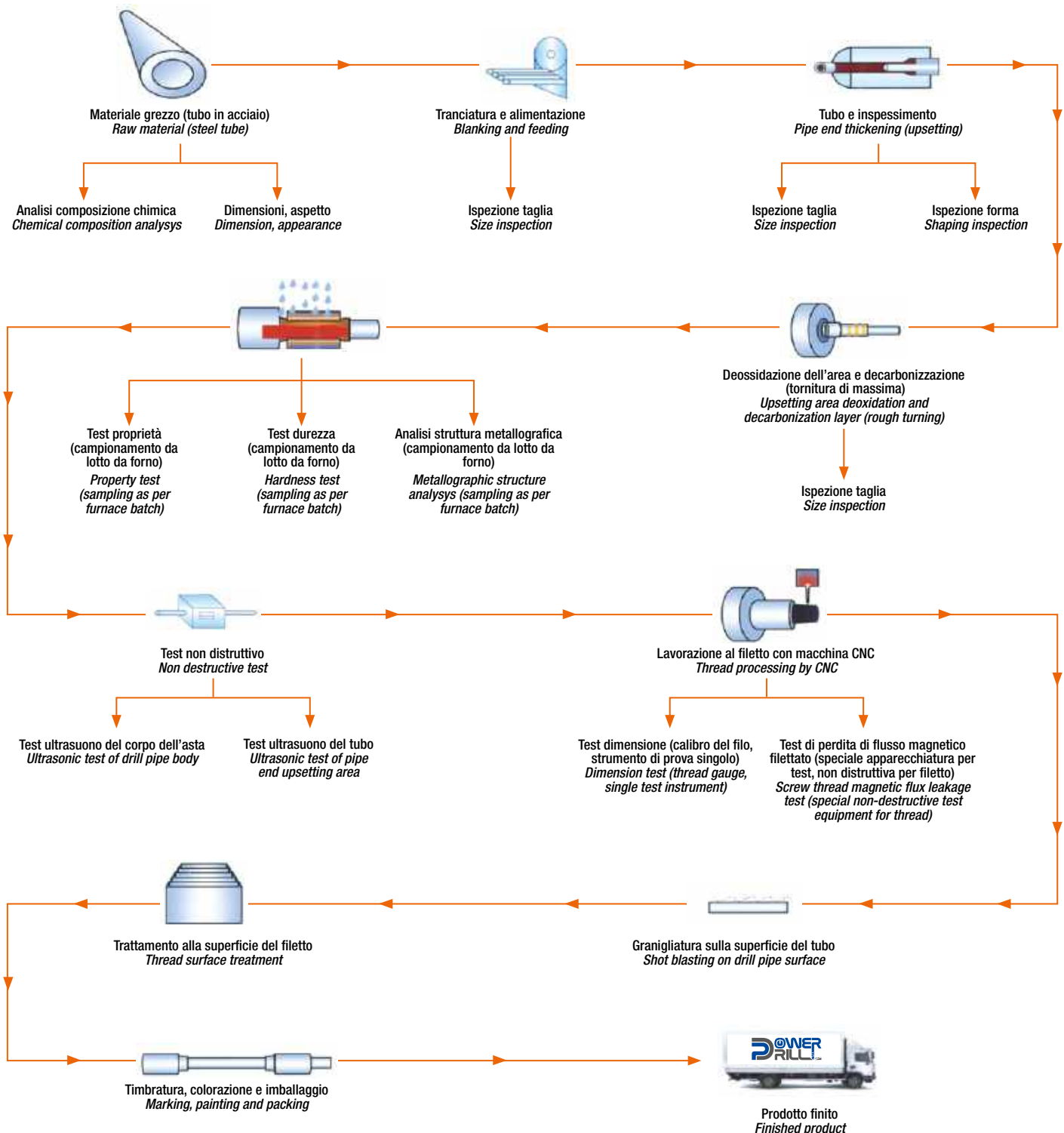



modelli compatibili / model compatibility

Model Compatibility	Thread	OD of Drill Pipe Body	OD of the Joint	Tool Joint ID	Wall Thickness of Tube	Pin Length	Working Length	Tempering and Quenching	Recommender Connection Torque	Torque	Bend radius	Angle	Bend Slope Ratio
	Type	mm	mm	mm	mm	mm	mm	Grade	Nm	Nm	m	°	%
JT520	DW 1.21	28,7	44,45	9	5	27,94	1,5	5135	780	1220	29,5	2,9	19,7
JT920/JT921	DW 1.41	42,3	50,8	10	6,5	56,9	2	5135	1757	2929	28	4,1	14
JT920L	DW 1.41	42,3	50,8	10	6	56,9	3,05	5135	1757	2929	28,1	6,2	9,2
JT1720	DW 1.69	54	63,5	16,5	6,5	74	3	5135	4063	6772	35,8	4,8	11,9
JT2020/JT20	DW 1.94	54	66,7	19	7,5	75	3	5135	4944	8240	35,8	4,9	11,8
JT2720	DW 1.94	60,3	70	17	7,5	75	3	5135	4305	7175	40	4,3	13,3
JT25/JT30	DW 2.11	60,3	70	21	8	84,7	3	5135	6325	10542	40	4,3	13,3
JT25/JT2720M1/3020M1	DW 2.11	60,3	76	19	8,5	84,7	3	5135	11088	18480	40	4,3	13,3
JT4020 (old)	DW 2.4	73	82,5	25	10	99,5	4,5	5135	8064	13440	48,5	5,3	10,8
JT4020M1	DW 2.59	73	89	30	10,5	91,4	4,5	5135	10970	18284	51,4	5,3	10,8
JT7020/8020	DW 3.27	88,9	101,6	35	9,35	132,5	4,5	v	16274	27132	54	4,4	13,1

Model Compatibility	Thread	OD of Drill Pipe Body	OD of the Joint	Tool Joint ID	Wall Thickness of Tube	Pin Length	Working Length	Tempering and Quenching	Torque	Bend radius
	Type	mm	mm	mm	mm	mm	mm	Grade	Nm	m
D6x6	FS1 #200	38	48	19	5,5	50,7	1829	S135	1220	17,47
D7x11, D10x15 S3	FS1 #200	42,2	48	19	6	50,7	1829	S135	2040	29
D10x14, D10x15	FS1 #200	42,2	48	19	6	50,7	3048	S135	2040	29
D16x20A, D16x22 Series I, D20x22 S3	FS1 #250	48,26	54	19	6	63,5	3048	S135	2720	30
D20x22A, D20x22 Series II, D20x22 S3	FS1 #400	52,4	57	22	6,5	63,5	3048	S135	3536	31
D24x40, D24x40a, D24x40 Series II D23x30 S3, d24x40 S3	FS1 #600	60,3	66,7	22	7,1	63,5	3048	S135	5440	33
D40x40	FS1 #600	60,3	66,7	22	7,1	63,5	4572	S135	5440	33
D33x44, D36x50, D36x50 Series II	FS1 #650	60,3	70	22	7,5	63,5	3048	S135	6800	33
D33x44, D36x50, D36x50 Series I	FS1 #650	60,3	70	22	7,5	63,5	4572	S135	6800	33
D36x50, D36x50 Series I, D40x55 S3	FS1 #700	68	79	28	10,54	76,2	3048	S135	6800	44,2
D36x50, D36x50 Series II	FS1 #700	68	79	28	10,54	76,2	4572	S135	6800	44,2
D50x100, D60x70	FS1 #900	73	82,55	30	9,5	88,9	3048	S135	12240	51,4
D50x100, D50x100A, D60x90	FS1 #900	73	82,55	30	9,5	88,9	4572	S135	12240	51,4
D50x100, D80x100 Series II, D60x90	FS1 #800	88,9	92	38	9,35	88,9	4572	S135	13600	51,4
D100x120 Series I, D130x150, D60x90 D60x90 S3, D100x140, D100x140 S3	FS1 #1000	89	111	57	12	88,9	6096	S135	20400	60,2
D55x100	#902	73	98	50,8	10	88,9	4572	S135	17628	52
D33x44, D36x50, D36x50 Series I	FS2	60,3	70	30	7,5	70	3048	S135	6800	33
D33x44, D36x50, D36x50 Series II	FS2	60,3	70	30	7,5	70	4572	S135	6800	33
D100x200	FS2	88,9	104,8	57	10	88,9	6096	S135	24480	60,2

modelli compatibili / model compatibility

Drill thread	Model(s)
1.21	JT520
1.1	JT5
#200 (HIWS1)	JT520 / JT5
1.41	JT920 / JT920L / JT921 / JT921S
1.41	JT922 Fine Thread
1.3	JT9 / JT10 / JT922 Coarse Thread
#200 (HIWS1)	JT9 / JT10
1.47	JT1220M1
#250	JT1220M1
1.69	JT1220M1
1.94	JT2020M1 / JT20
#400 (HIWS1)	JT2020M1 / JT20
#600 (HIWS1)	JT2020M1 / JT20
2.11	JT2720M1
2.11	JT3020 / JT30
#600 (HIWS1)	JT3020 / JT30
2.59	JT4020M1
3.27	JT7020 / JT8020 / JT100
3.27	JT100 New Gear Box
#800 (HIWS1)	JT7020 / JT8020 / JT100-Legacy
#800 (HIWS1)	JT100 New Gear Box
2.77 DS	AT2720
2.77 SS	AT2720 Cobble
2.77 DS	AT30
2.77 SS	AT30 Cobble
3.25 SS	AT4020
3.44 SS	AT100 New Gear Box
#800 (HIWS1)	AT100 New Gear Box
3.27	AT100 New Gear Box



Model Compatibility	Length Shoulder to shoulder	Rod Diameter	Drill Rod Thread
D7x11a, D10x14, D10x15	5.83" (14,8 cm)	1.66" (4,2 cm)	#200
D6x6 - D10x15 S3	8" (20,3 cm)	1.66" (4,2 cm)	#200
D16x20 - D20x22	4" (10,2 cm)	1.9" (4,8 cm)	#250
D18x22 - D20x22	6.5" (16,5 cm)	2.06" (5,2 cm)	#400
D16x20 Series II, D20x22 S3	10.14" (25,8 cm)	1.9" (4,9 cm)	#250
D20x22fx Series II	10.14" (25,8 cm)	2.06" (5,2 cm)	#400
D20x22 Series II, D20x22 S3, D23x30 S3	10.14" (25,8 cm)	2.06" (5,2 cm)	#400
D23x30 S3	10.14" (25,8 cm)	2.375" (6 cm)	#600
D24x20a (SN 001 - 382)	5.5" (14 cm)	2.375" (6 cm)	#600
D24x40a (SN 383 and above)	7" (17,8 cm)	2.375" (6 cm)	#600
D24x40 Series II	9.5" (24,1 cm)	2.375" (6 cm)	#600
D24x40 S3	10" (25,4 cm)	2.375" (6 cm)	#600
D36x50 Series II	7.92" (20,1 cm)	2.375" (6 cm)	#600
D36x50, D36x50 Series II	8.5" (21,6 cm)	2.625" (6,7 cm)	#700
D36x50dr Series II (outer rod)	12" (30,5 cm)	2.625" (6,7 cm)	#750
D36x50dr Series II (inner rod)	12.5" (31,8 cm)	1.66" (4,2 cm)	#200
D40x55 S3	8.92" (22,7 cm)	2.375" (6 cm)	#650
D40x55 S3	9.5" (24,1 cm)	2.625" (6,7 cm)	#700
D50x100a - For drive chuck 296355366	5.82" (14,8 cm)	2.875" (7,3 cm)	#900
D50x100a, D60x90, D60x90 S3, D80x100 For drive chucks 296255475, 296268832	7.02" (17,8 cm)	3.5 (8,9 cm)	#800
D60x90, D60x90 S3 For drive chucks 296357202, 296257222	8.7" (22 cm)	2.875" (7,3 cm)	#900
D100x120 Series II, D100x140, D100x140 S3 For drive chucks 296309516, 296309602	7.02" (17,8 cm)	3.5 (8,9 cm)	#1000

Realizziamo su misura palette di perforazione adattabili a tutte le macchine presenti sul mercato.

Acciai strutturali di alta qualità e inserti in carburo di tungsteno per garantirvi performance efficaci.

***We realize customized perforation bit adaptable to all machines on the market.
We have high quality structural steel and Tungsten carbide insert, to guarantee high performances.***

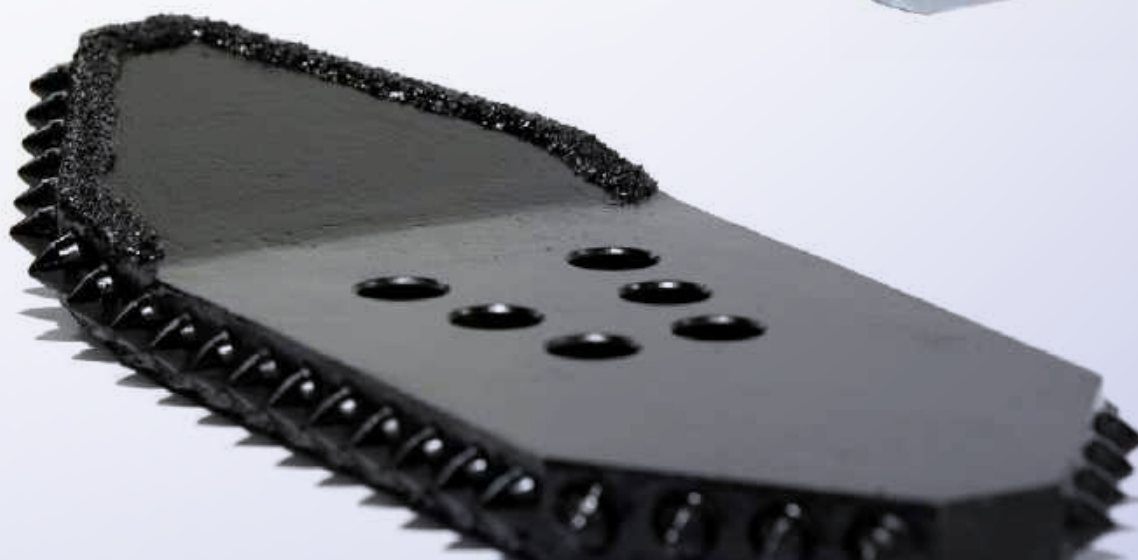

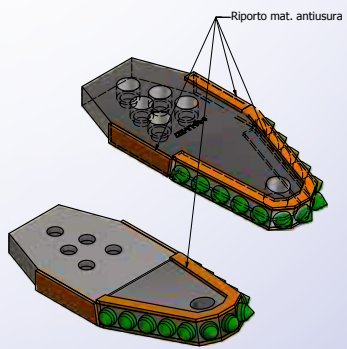
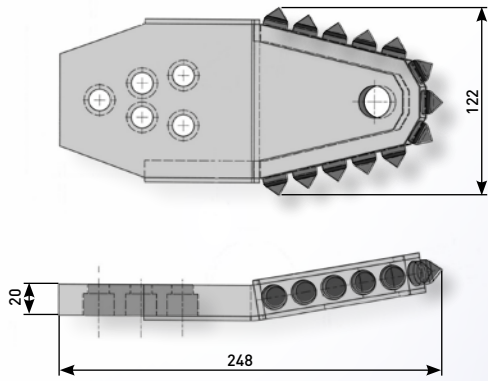

PDP059

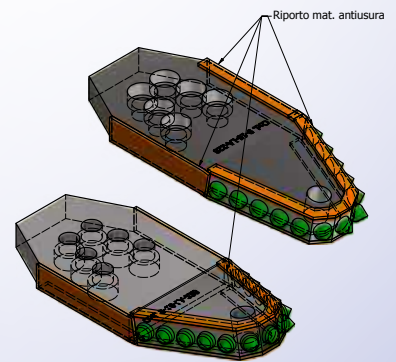
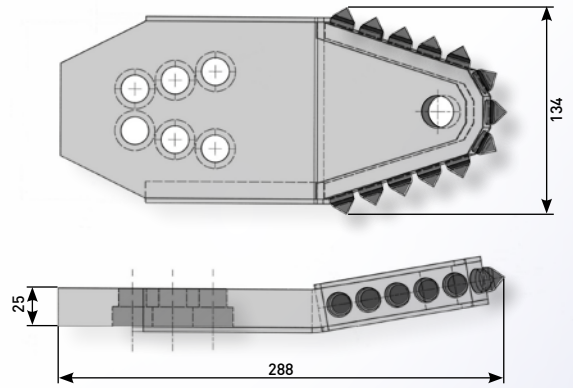

PDP060

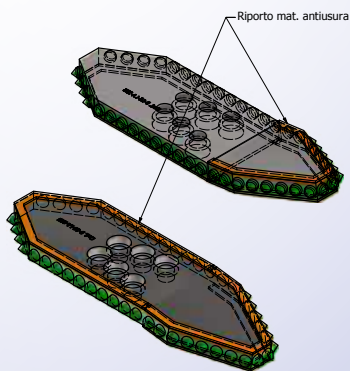
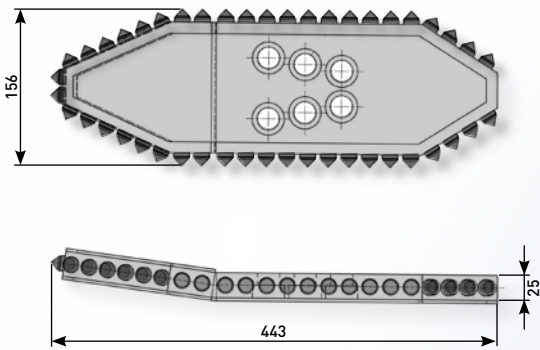

PDP061

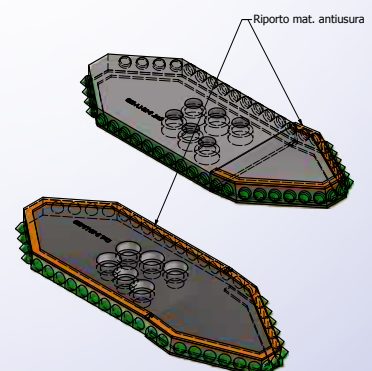
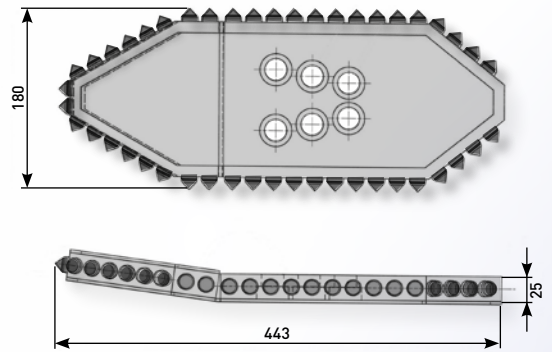

PDP062

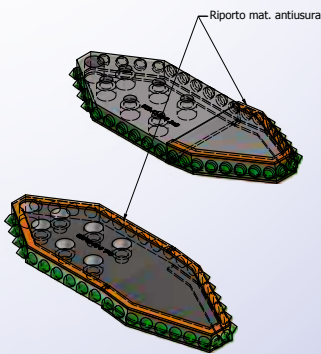
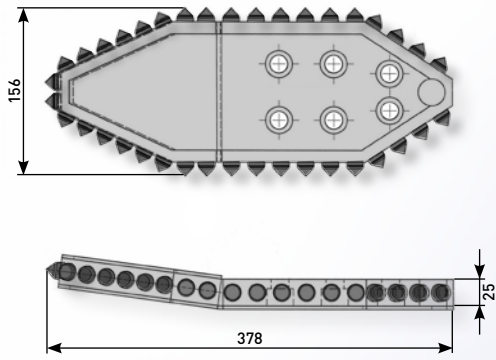

PDP064

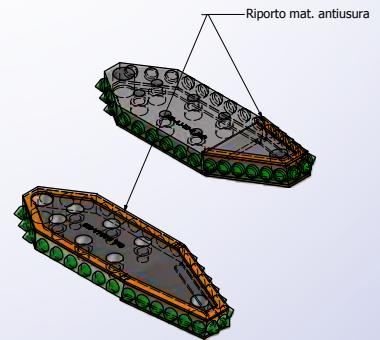
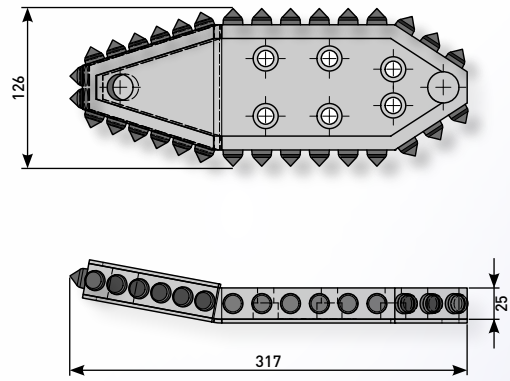

PDP091

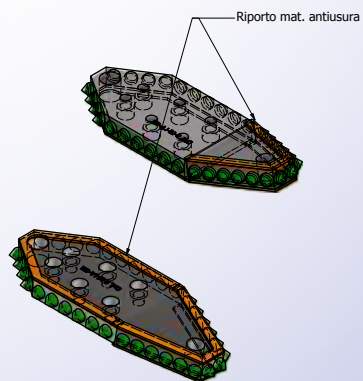
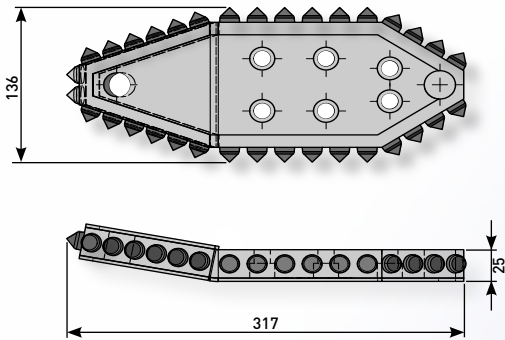

PDP092



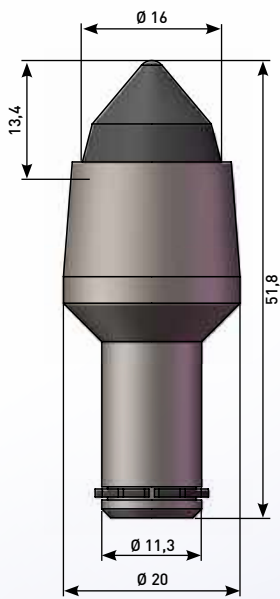

machine size



hardness



packing



PDT1611

Picco diametro 11 inserto 16x13.3.
Tool diameter 11 insert 16x13.3.

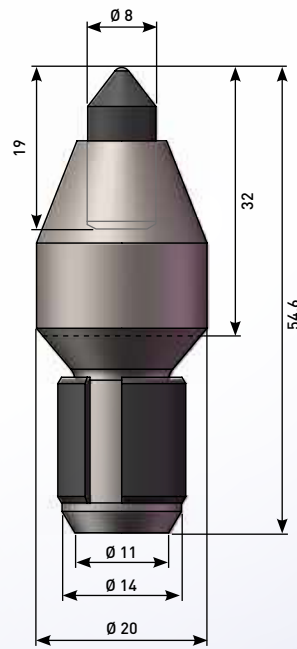

machine size



hardness



packing



PDT814

Picco diametro 14.
Tool diameter 14.

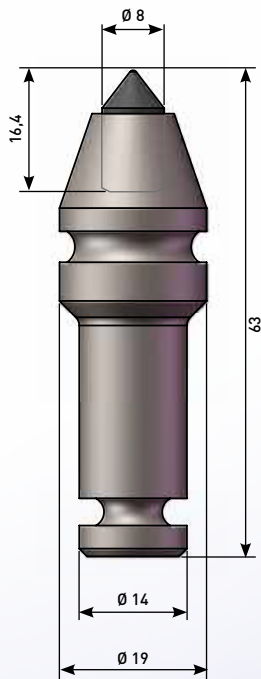

machine size



hardness



packing



PDT814C

Picco diametro 14 inserto 8x16.4.
Tool diameter 14 insert 8x16.4.

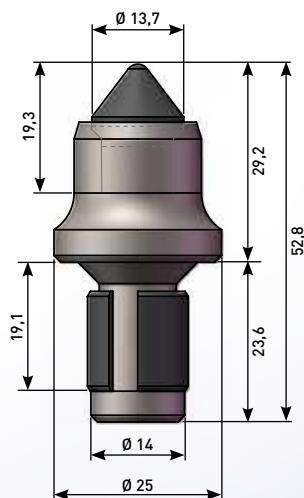

machine size



hardness



packing



PDT1414

Picco diametro 14 inserto 13.7x19.3.
Tool diameter 14 insert 13.7x19.3.



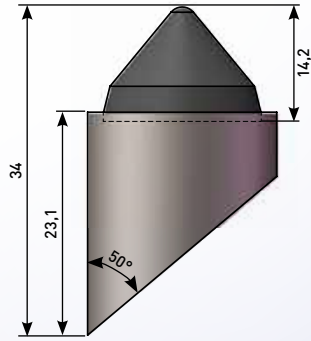
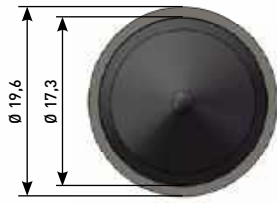

PDFBR1

Alesatore inserto 17.3x14.2.
Reamer tungsten carbide insert 17.3x14.2.

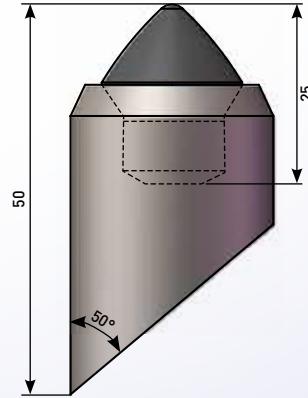
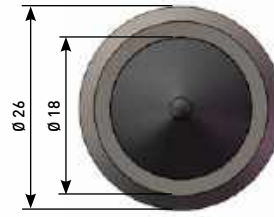

PDFBR3

Alesatore inserto 18x25.
Reamer tungsten carbide insert 18x25.

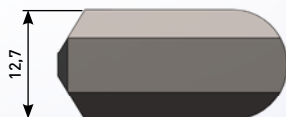
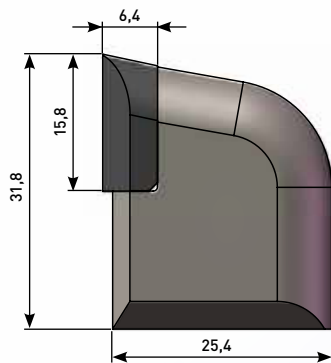

PDFRT1

Allargatore inserto 12x15x6.
Reamer tungsten carbide insert 12x15x6.

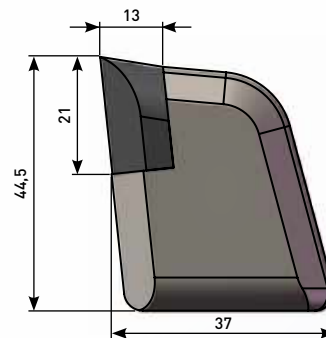

PDFRT2

Allargatore inserto 12x15x6.
Reamer tungsten carbide insert 12x15x6.

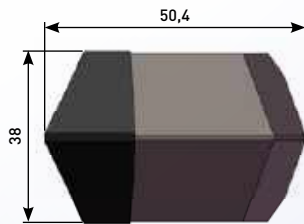
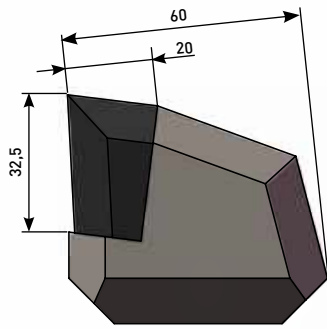

PDF38

Allgatore inserto 38x32,5x20.
Reamer tungsten carbide insert 38x32,5x20.

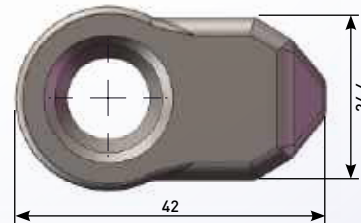
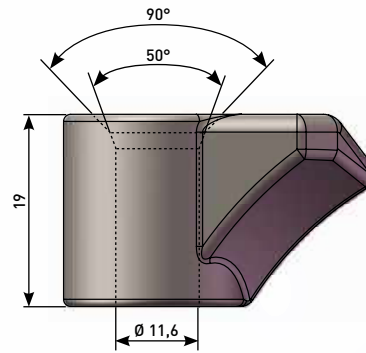

PDB11

Supporto diametro 11.
Toolholder diameter 11.

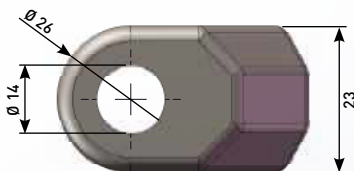
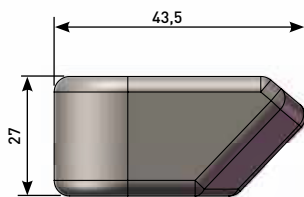

PDB14

Supporto diametro 14.
Toolholder diameter 14.

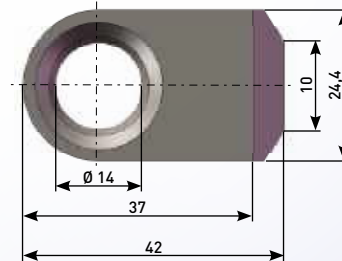
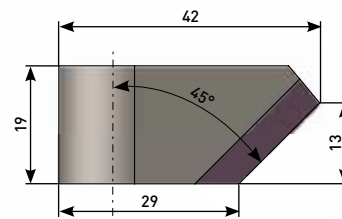

PDB14HD

Supporto diametro 14.
Toolholder diameter 14.











Website: www.powerdrill.info
E-mail: info@powerdrill.info